

(B) PROPOSED EASEMENT FOR RETAINING WALL SUPPORT 0.5m WIDE

(D) PROPOSED EASEMENT TO DRAIN WATER 2.0m WIDE



LEGEND

- EASEMENT FOR DRAINAGE & SERVICES
- ▬ RETAINING WALL
- ▬ DRAINAGE LINE & PIT
- S — SEWER MAIN
- W — WATER MAIN
- 58.0 — FINISHED SURFACE LEVEL

- E — ELECTRICITY
- NBN — COMMUNICATIONS
- STREET LIGHT
- EP ELECTRICAL PILLAR
- NBN COMMUNICATIONS PIT
- ⊕ ⊖ WATER HYDRANT, STOP VALVE & SCOUR

- ⊙ ⊙ SEWER MAINTENANCE CHAMBER, HOLE & TERMINAL MAINTENANCE SHAFT
- ▬ BATTER
- ▬ VEHICULAR CROSSING & DRIVEWAY
- 🌳 STREET TREE

09/04/2026

This plan is provided solely for the purpose of providing an impression of the concept relating to the proposed development called 'Orchard Hills North', as well as the approximate location of existing and proposed third party facilities, services or destinations, and is not intended to be used for any other purpose. Legacy Group does not make any representation or give any warranty in relation to the future development of the site, the staging of any future development or the current or future location or existence of any facilities, services or destinations. The plan is based on the present intention of, and information available to, Legacy Group and the current known requirements of relevant authorities at the time of creation of the plan and details may change due to future circumstances. Any indications of distance or size are approximate and for indicative purposes only and are not to scale. The plan and any matters shown on or inferred from it do not give rise to a legally binding obligation on or representation or warranty by Legacy Group. Legacy Group accepts no liability for any loss or damage arising as a result of any reliance on this plan or its contents. Branding & Marketing by Delivery.net.au



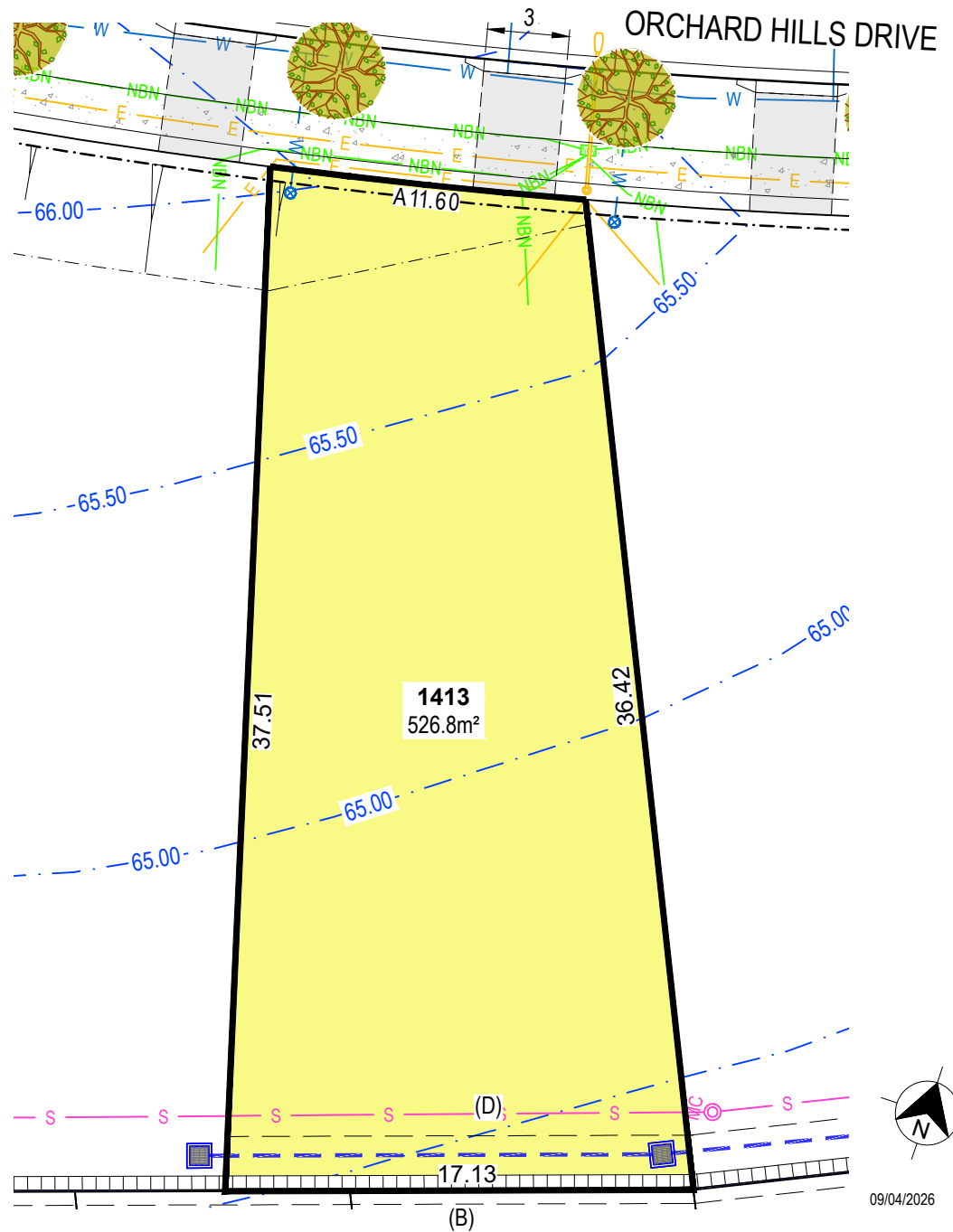

09/04/2026

This plan is provided solely for the purpose of providing an impression of the concept relating to the proposed development called 'Orchard Hills North', as well as the approximate location of existing and proposed third party facilities, services or destinations, and is not intended to be used for any other purpose. Legacy Group does not make any representation or give any warranty in relation to the future development of the site, the staging of any future development or the current or future location or existence of any facilities, services or destinations. The plan is based on the present intention of, and information available to, Legacy Group and the current known requirements of relevant authorities at the time of creation of the plan and details may change due to future circumstances. Any indications of distance or size are approximate and for indicative purposes only and are not to scale. The plan and any matters shown on or inferred from it do not give rise to a legally binding obligation on or representation or warranty by Legacy Group. Legacy Group accepts no liability for any loss or damage arising as a result of any reliance on this plan or its contents. Branding & Marketing by Delivery.net.au

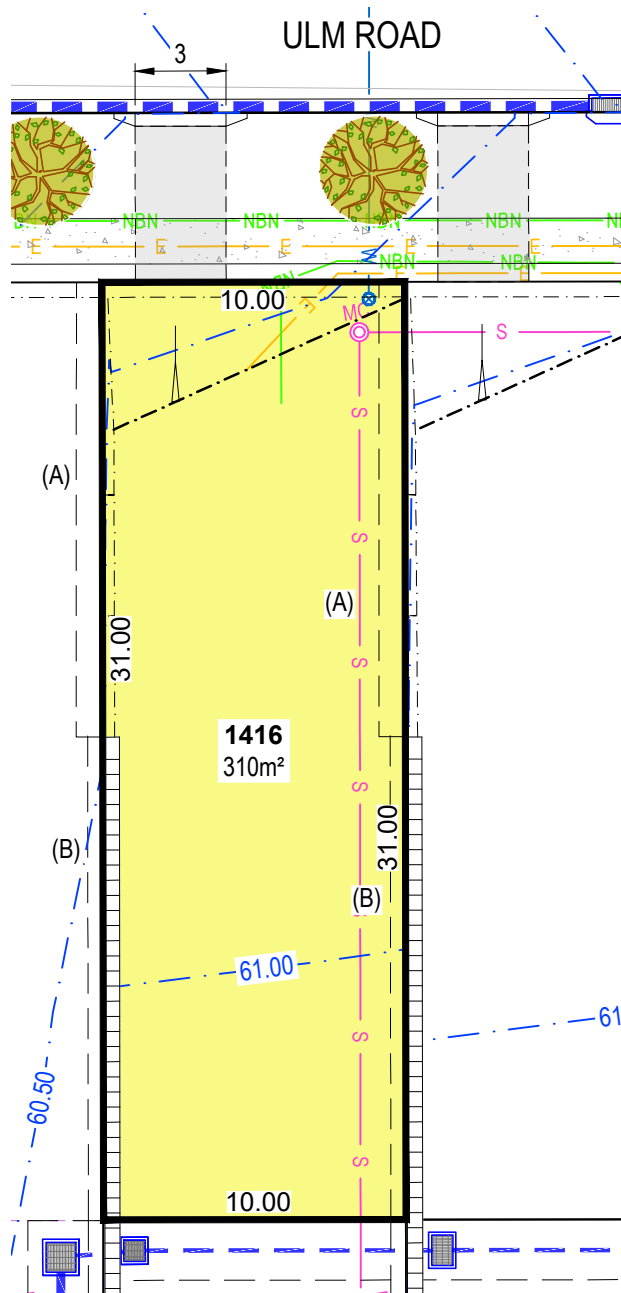

- (A) PROPOSED EASEMENT FOR ACCESS & MAINTENANCE 0.9m WIDE
- (B) PROPOSED EASEMENT FOR RETAINING WALL SUPPORT 0.5m WIDE
- (C) PROPOSED TEMPORARY EASEMENT TO DRAIN WATER 2.5m WIDE
- (D) PROPOSED EASEMENT TO DRAIN WATER 2.0m WIDE
- (H) PROPOSED EASEMENT TO DRAIN WATER 2.7 WIDE & VARIABLE



LEGEND

	EASEMENT FOR DRAINAGE & SERVICES		ELECTRICITY		SEWER MAINTENANCE CHAMBER, HOLE & TERMINAL MAINTENANCE SHAFT
	RETAINING WALL		COMMUNICATIONS		BATTER
	DRAINAGE LINE & PIT		STREET LIGHT		VEHICULAR CROSSING & DRIVEWAY
	SEWER MAIN		ELECTRICAL PILLAR		STREET TREE
	WATER MAIN		COMMUNICATIONS PIT		
	FINISHED SURFACE LEVEL		WATER HYDRANT, STOP VALVE & SCOUR		

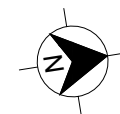

18/03/2026

This plan is provided solely for the purpose of providing an impression of the concept relating to the proposed development called 'Orchard Hills North', as well as the approximate location of existing and proposed third party facilities, services or destinations, and is not intended to be used for any other purpose. Legacy Group does not make any representation or give any warranty in relation to the future development of the site, the staging of any future development or the current or future location or existence of any facilities, services or destinations. The plan is based on the present intention of, and information available to, Legacy Group and the current known requirements of relevant authorities at the time of creation of the plan and details may change due to future circumstances. Any indications of distance or size are approximate and for indicative purposes only and are not to scale. The plan and any matters shown on or inferred from it do not give rise to a legally binding obligation on or representation or warranty by Legacy Group. Legacy Group accepts no liability for any loss or damage arising as a result of any reliance on this plan or its contents. Branding & Marketing by Delivery.net.au



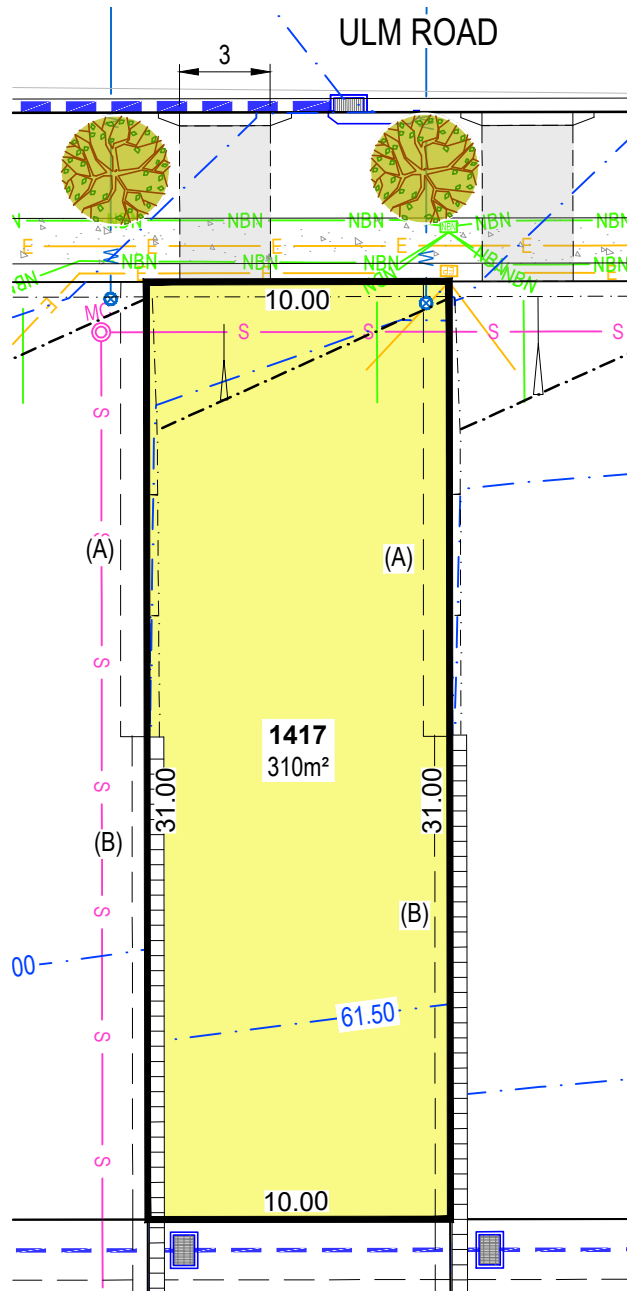

- (A) PROPOSED EASEMENT FOR ACCESS & MAINTENANCE 0.9m WIDE
- (B) PROPOSED EASEMENT FOR RETAINING WALL SUPPORT 0.5m WIDE
- (C) PROPOSED TEMPORARY EASEMENT TO DRAIN WATER 2.5m WIDE
- (D) PROPOSED EASEMENT TO DRAIN WATER 2.0m WIDE
- (H) PROPOSED EASEMENT TO DRAIN WATER 2.7 WIDE & VARIABLE

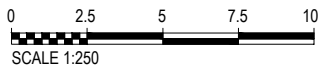

LEGEND

- | | | | | | |
|----------|----------------------------------|---------|-----------------------------------|---|--|
| --- | EASEMENT FOR DRAINAGE & SERVICES | — E — | ELECTRICITY | ⊙ | SEWER MAINTENANCE CHAMBER, HOLE & TERMINAL MAINTENANCE SHAFT |
| ▤ | RETAINING WALL | — NBN — | COMMUNICATIONS | ⊙ | BATTER |
| — W — | DRAINAGE LINE & PIT | — S — | STREET LIGHT | — | VEHICULAR CROSSING & DRIVEWAY |
| — S — | SEWER MAIN | EP | ELECTRICAL PILLAR | ⊙ | STREET TREE |
| — W — | WATER MAIN | ⊙ | COMMUNICATIONS PIT | | |
| — 58.0 — | FINISHED SURFACE LEVEL | ⊙ | WATER HYDRANT, STOP VALVE & SCOUR | | |

18/03/2026

This plan is provided solely for the purpose of providing an impression of the concept relating to the proposed development called 'Orchard Hills North', as well as the approximate location of existing and proposed third party facilities, services or destinations, and is not intended to be used for any other purpose. Legacy Group does not make any representation or give any warranty in relation to the future development of the site, the staging of any future development or the current or future location or existence of any facilities, services or destinations. The plan is based on the present intention of, and information available to, Legacy Group and the current known requirements of relevant authorities at the time of creation of the plan and details may change due to future circumstances. Any indications of distance or size are approximate and for indicative purposes only and are not to scale. The plan and any matters shown on or inferred from it do not give rise to a legally binding obligation on or representation or warranty by Legacy Group. Legacy Group accepts no liability for any loss or damage arising as a result of any reliance on this plan or its contents. Branding & Marketing by Delivery.net.au

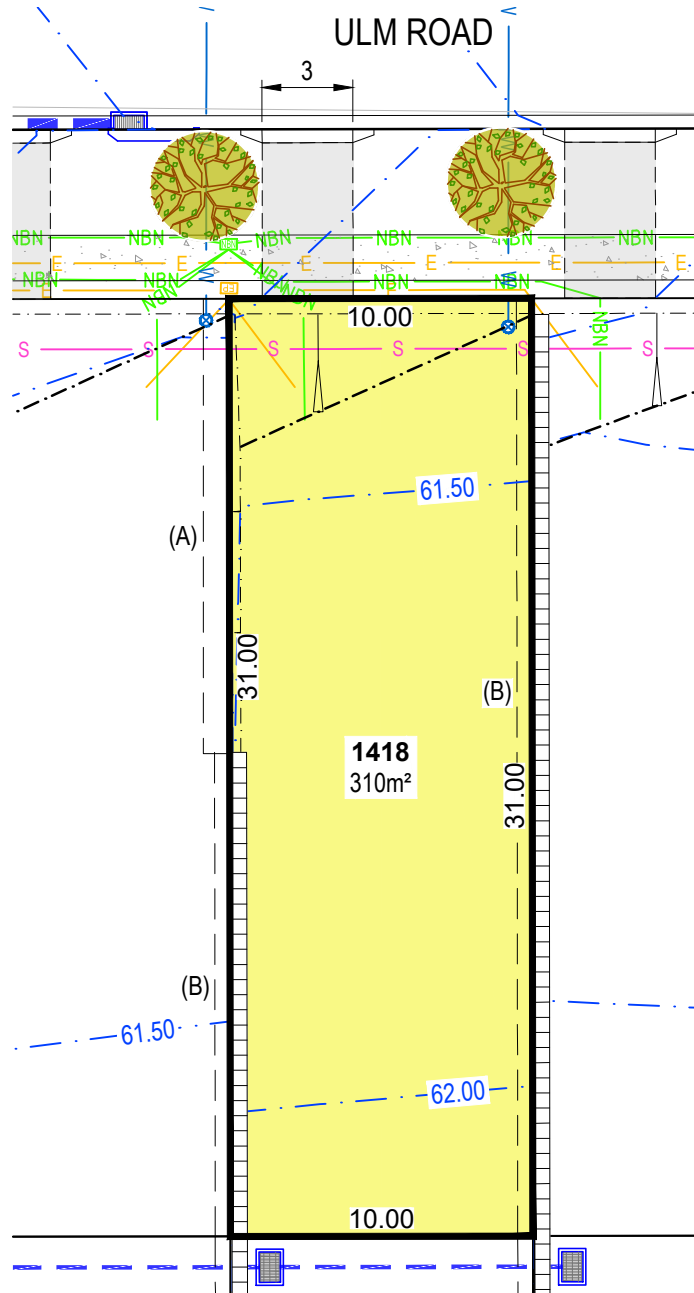

- (A) PROPOSED EASEMENT FOR ACCESS & MAINTENANCE 0.9m WIDE
- (B) PROPOSED EASEMENT FOR RETAINING WALL SUPPORT 0.5m WIDE
- (C) PROPOSED TEMPORARY EASEMENT TO DRAIN WATER 2.5m WIDE
- (D) PROPOSED EASEMENT TO DRAIN WATER 2.0m WIDE
- (H) PROPOSED EASEMENT TO DRAIN WATER 2.7 WIDE & VARIABLE



LEGEND

- | | | | | | |
|----------|----------------------------------|---------|-----------------------------------|---------|--|
| --- | EASEMENT FOR DRAINAGE & SERVICES | — E — | ELECTRICITY | ⊙ ⊙ ⊙ | SEWER MAINTENANCE CHAMBER, HOLE & TERMINAL MAINTENANCE SHAFT |
| ▤ | RETAINING WALL | — NBN — | COMMUNICATIONS | ⊙ | BATTER |
| — [] — | DRAINAGE LINE & PIT | — [] — | STREET LIGHT | — [] — | VEHICULAR CROSSING & DRIVEWAY |
| — S — | SEWER MAIN | [EP] | ELECTRICAL PILLAR | — [] — | STREET TREE |
| — W — | WATER MAIN | [NBN] | COMMUNICATIONS PIT | | |
| — 58.0 — | FINISHED SURFACE LEVEL | ⊕ ⊕ ⊕ | WATER HYDRANT, STOP VALVE & SCOUR | | |

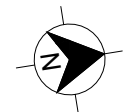

18/03/2026

This plan is provided solely for the purpose of providing an impression of the concept relating to the proposed development called 'Orchard Hills North', as well as the approximate location of existing and proposed third party facilities, services or destinations, and is not intended to be used for any other purpose. Legacy Group does not make any representation or give any warranty in relation to the future development of the site, the staging of any future development or the current or future location or existence of any facilities, services or destinations. The plan is based on the present intention of, and information available to, Legacy Group and the current known requirements of relevant authorities at the time of creation of the plan and details may change due to future circumstances. Any indications of distance or size are approximate and for indicative purposes only and are not to scale. The plan and any matters shown on or inferred from it do not give rise to a legally binding obligation on or representation or warranty by Legacy Group. Legacy Group accepts no liability for any loss or damage arising as a result of any reliance on this plan or its contents. Branding & Marketing by Delivery.net.au



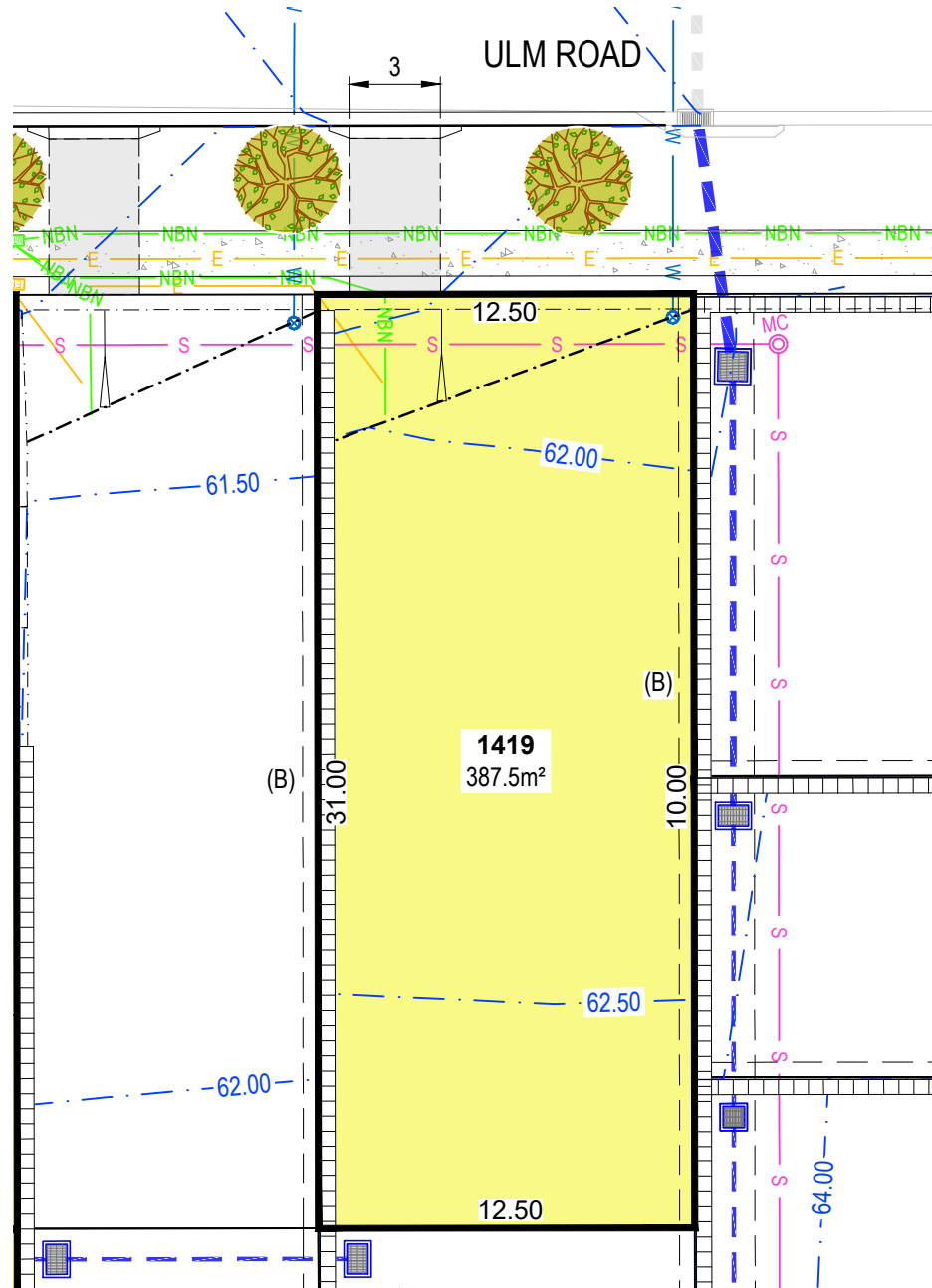

- (A) PROPOSED EASEMENT FOR ACCESS & MAINTENANCE 0.9m WIDE
- (B) PROPOSED EASEMENT FOR RETAINING WALL SUPPORT 0.5m WIDE
- (C) PROPOSED TEMPORARY EASEMENT TO DRAIN WATER 2.5m WIDE
- (D) PROPOSED EASEMENT TO DRAIN WATER 2.0m WIDE
- (H) PROPOSED EASEMENT TO DRAIN WATER 2.7 WIDE & VARIABLE



LEGEND

---	EASEMENT FOR DRAINAGE & SERVICES	— E —	ELECTRICITY	⊙	SEWER MAINTENANCE CHAMBER, HOLE & TERMINAL MAINTENANCE SHAFT
▤	RETAINING WALL	— NBN —	COMMUNICATIONS	⊙	BATTER
— S —	DRAINAGE LINE & PIT	—	STREET LIGHT	—	VEHICULAR CROSSING & DRIVEWAY
— W —	SEWER MAIN	⊙	ELECTRICAL PILLAR	⊙	STREET TREE
— 58.0 —	WATER MAIN	⊙	COMMUNICATIONS PIT		
— 58.0 —	FINISHED SURFACE LEVEL	⊙	WATER HYDRANT, STOP VALVE & SCOUR		

18/03/2026

This plan is provided solely for the purpose of providing an impression of the concept relating to the proposed development called 'Orchard Hills North', as well as the approximate location of existing and proposed third party facilities, services or destinations, and is not intended to be used for any other purpose. Legacy Group does not make any representation or give any warranty in relation to the future development of the site, the staging of any future development or the current or future location or existence of any facilities, services or destinations. The plan is based on the present intention of, and information available to, Legacy Group and the current known requirements of relevant authorities at the time of creation of the plan and details may change due to future circumstances. Any indications of distance or size are approximate and for indicative purposes only and are not to scale. The plan and any matters shown on or inferred from it do not give rise to a legally binding obligation on or representation or warranty by Legacy Group. Legacy Group accepts no liability for any loss or damage arising as a result of any reliance on this plan or its contents. Branding & Marketing by Delivery.net.au



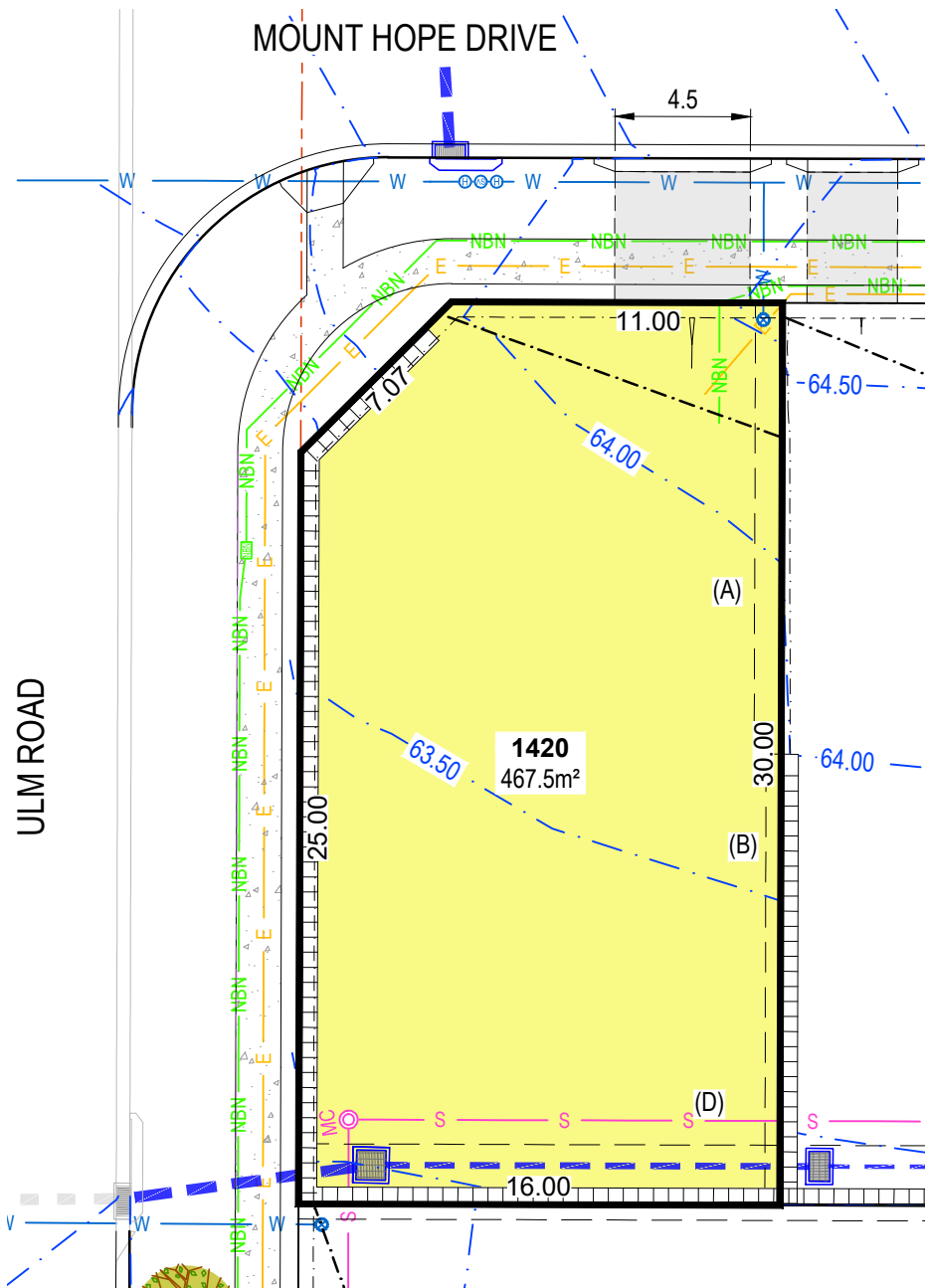

- (A) PROPOSED EASEMENT FOR ACCESS & MAINTENANCE 0.9m WIDE
- (B) PROPOSED EASEMENT FOR RETAINING WALL SUPPORT 0.5m WIDE
- (C) PROPOSED TEMPORARY EASEMENT TO DRAIN WATER 2.5m WIDE
- (D) PROPOSED EASEMENT TO DRAIN WATER 2.0m WIDE
- (H) PROPOSED EASEMENT TO DRAIN WATER 2.7 WIDE & VARIABLE



LEGEND

- | | | | | | |
|----------|----------------------------------|---------|-----------------------------------|---------|--|
| --- | EASEMENT FOR DRAINAGE & SERVICES | — E — | ELECTRICITY | ⊙ ⊠ ⊙ | SEWER MAINTENANCE CHAMBER, HOLE & TERMINAL MAINTENANCE SHAFT |
| ▤ | RETAINING WALL | — NBN — | COMMUNICATIONS | ⊕ | BATTER |
| — [] — | DRAINAGE LINE & PIT | — [] — | STREET LIGHT | — [] — | VEHICULAR CROSSING & DRIVEWAY |
| — S — | SEWER MAIN | [EP] | ELECTRICAL PILLAR | ⊕ | STREET TREE |
| — W — | WATER MAIN | [NBN] | COMMUNICATIONS PIT | | |
| — 58.0 — | FINISHED SURFACE LEVEL | ⊕ ⊕ ⊕ | WATER HYDRANT, STOP VALVE & SCOUR | | |

18/03/2026

This plan is provided solely for the purpose of providing an impression of the concept relating to the proposed development called 'Orchard Hills North', as well as the approximate location of existing and proposed third party facilities, services or destinations, and is not intended to be used for any other purpose. Legacy Group does not make any representation or give any warranty in relation to the future development of the site, the staging of any future development or the current or future location or existence of any facilities, services or destinations. The plan is based on the present intention of, and information available to, Legacy Group and the current known requirements of relevant authorities at the time of creation of the plan and details may change due to future circumstances. Any indications of distance or size are approximate and for indicative purposes only and are not to scale. The plan and any matters shown on or inferred from it do not give rise to a legally binding obligation on or representation or warranty by Legacy Group. Legacy Group accepts no liability for any loss or damage arising as a result of any reliance on this plan or its contents. Branding & Marketing by Delivery.net.au

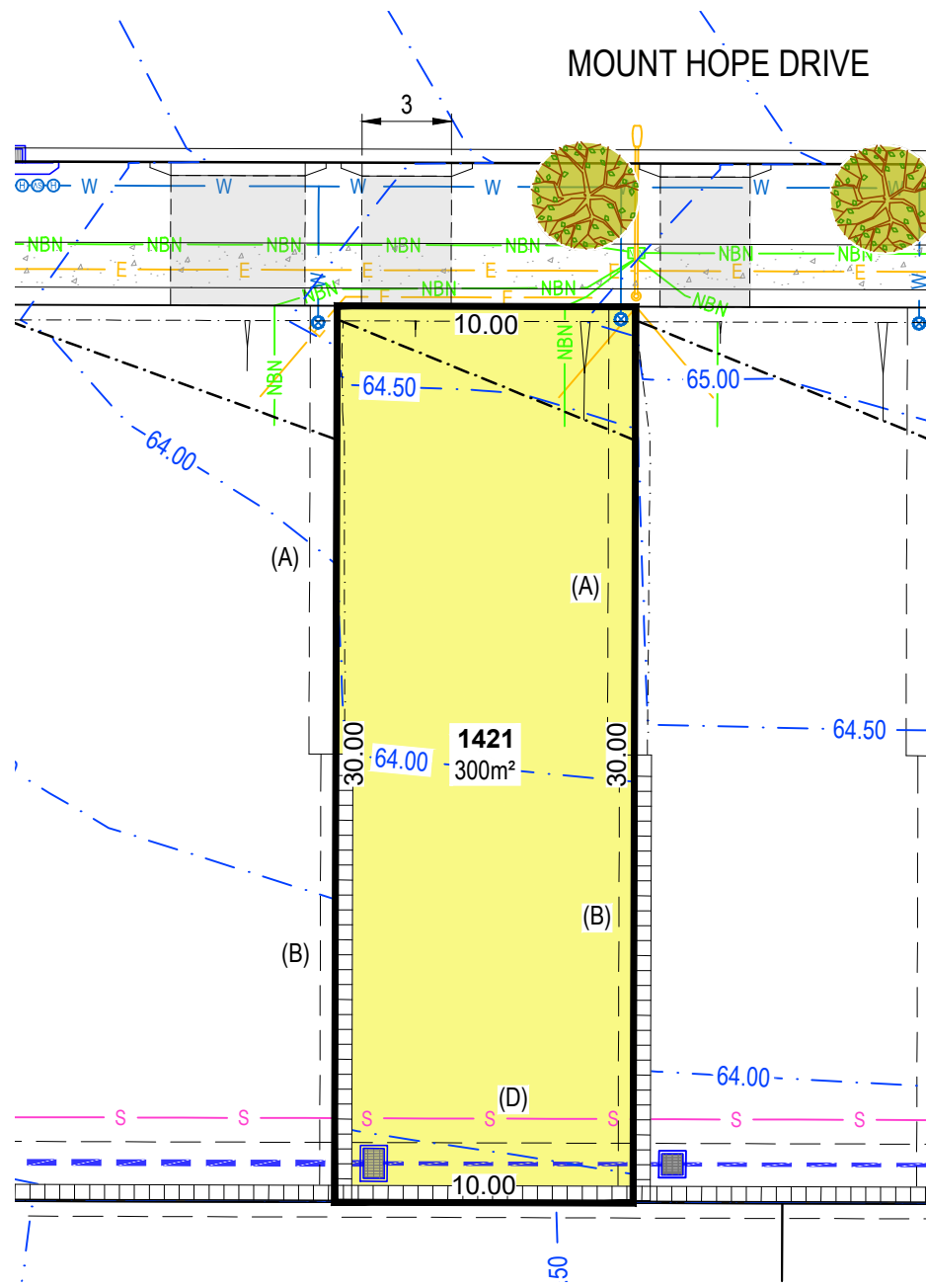

- (A) PROPOSED EASEMENT FOR ACCESS & MAINTENANCE 0.9m WIDE
- (B) PROPOSED EASEMENT FOR RETAINING WALL SUPPORT 0.5m WIDE
- (C) PROPOSED TEMPORARY EASEMENT TO DRAIN WATER 2.5m WIDE
- (D) PROPOSED EASEMENT TO DRAIN WATER 2.0m WIDE
- (H) PROPOSED EASEMENT TO DRAIN WATER 2.7 WIDE & VARIABLE



LEGEND

- | | | | | | |
|----------|----------------------------------|---------|-----------------------------------|-------|--|
| --- | EASEMENT FOR DRAINAGE & SERVICES | — E — | ELECTRICITY | ⊗ ⊠ ⊗ | SEWER MAINTENANCE CHAMBER, HOLE & TERMINAL MAINTENANCE SHAFT |
| ▤ | RETAINING WALL | — NBN — | COMMUNICATIONS | ⊕ | BATTER |
| — S — | DRAINAGE LINE & PIT | — | STREET LIGHT | — | VEHICULAR CROSSING & DRIVEWAY |
| — S — | SEWER MAIN | ⊕ | ELECTRICAL PILLAR | — | STREET TREE |
| — W — | WATER MAIN | ⊕ | COMMUNICATIONS PIT | | |
| — 58.0 — | FINISHED SURFACE LEVEL | ⊕ ⊕ ⊕ | WATER HYDRANT, STOP VALVE & SCOUR | | |

18/03/2026

This plan is provided solely for the purpose of providing an impression of the concept relating to the proposed development called 'Orchard Hills North', as well as the approximate location of existing and proposed third party facilities, services or destinations, and is not intended to be used for any other purpose. Legacy Group does not make any representation or give any warranty in relation to the future development of the site, the staging of any future development or the current or future location or existence of any facilities, services or destinations. The plan is based on the present intention of, and information available to, Legacy Group and the current known requirements of relevant authorities at the time of creation of the plan and details may change due to future circumstances. Any indications of distance or size are approximate and for indicative purposes only and are not to scale. The plan and any matters shown on or inferred from it do not give rise to a legally binding obligation on or representation or warranty by Legacy Group. Legacy Group accepts no liability for any loss or damage arising as a result of any reliance on this plan or its contents. Branding & Marketing by Delivery.net.au





MOUNT HOPE DRIVE

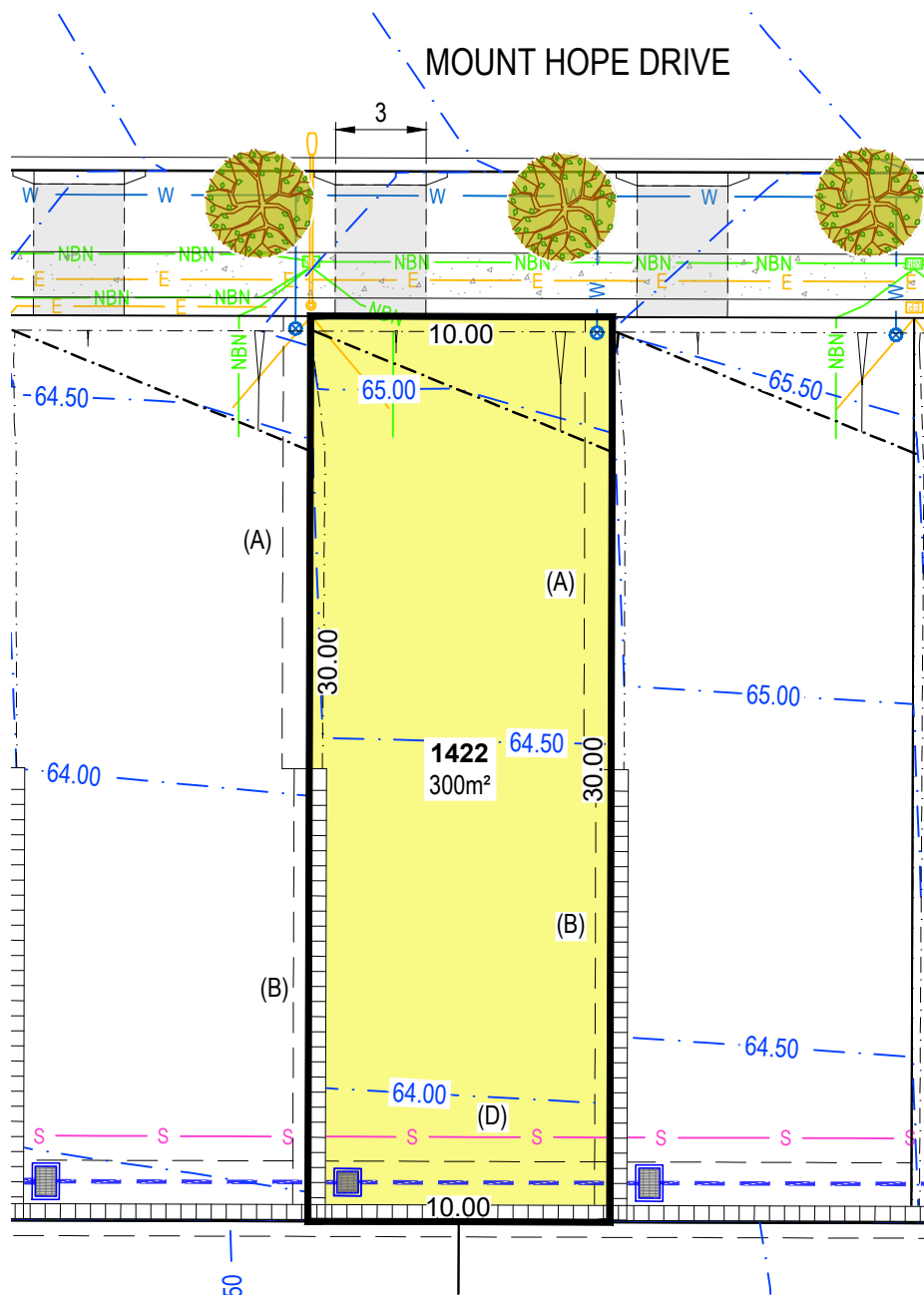

- (A) PROPOSED EASEMENT FOR ACCESS & MAINTENANCE 0.9m WIDE
- (B) PROPOSED EASEMENT FOR RETAINING WALL SUPPORT 0.5m WIDE
- (C) PROPOSED TEMPORARY EASEMENT TO DRAIN WATER 2.5m WIDE
- (D) PROPOSED EASEMENT TO DRAIN WATER 2.0m WIDE
- (H) PROPOSED EASEMENT TO DRAIN WATER 2.7 WIDE & VARIABLE

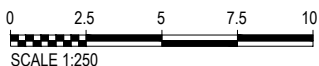

LEGEND

- | | | | | | |
|----------|----------------------------------|---------|-----------------------------------|--------|--|
| --- | EASEMENT FOR DRAINAGE & SERVICES | — E — | ELECTRICITY | ⊙ ⊙ ⊙ | SEWER MAINTENANCE CHAMBER, HOLE & TERMINAL MAINTENANCE SHAFT |
| ▬▬▬▬▬▬ | RETAINING WALL | — NBN — | COMMUNICATIONS | ⊙ | BATTER |
| — S — | DRAINAGE LINE & PIT | ⊙ | STREET LIGHT | ▬▬▬▬▬▬ | VEHICULAR CROSSING & DRIVEWAY |
| — S — | SEWER MAIN | ⊙ | ELECTRICAL PILLAR | ⊙ | STREET TREE |
| — W — | WATER MAIN | ⊙ | COMMUNICATIONS PIT | | |
| — 58.0 — | FINISHED SURFACE LEVEL | ⊙ ⊙ ⊙ | WATER HYDRANT, STOP VALVE & SCOUR | | |

18/03/2026

This plan is provided solely for the purpose of providing an impression of the concept relating to the proposed development called 'Orchard Hills North', as well as the approximate location of existing and proposed third party facilities, services or destinations, and is not intended to be used for any other purpose. Legacy Group does not make any representation or give any warranty in relation to the future development of the site, the staging of any future development or the current or future location or existence of any facilities, services or destinations. The plan is based on the present intention of, and information available to, Legacy Group and the current known requirements of relevant authorities at the time of creation of the plan and details may change due to future circumstances. Any indications of distance or size are approximate and for indicative purposes only and are not to scale. The plan and any matters shown on or inferred from it do not give rise to a legally binding obligation on or representation or warranty by Legacy Group. Legacy Group accepts no liability for any loss or damage arising as a result of any reliance on this plan or its contents. Branding & Marketing by Delivery.net.au



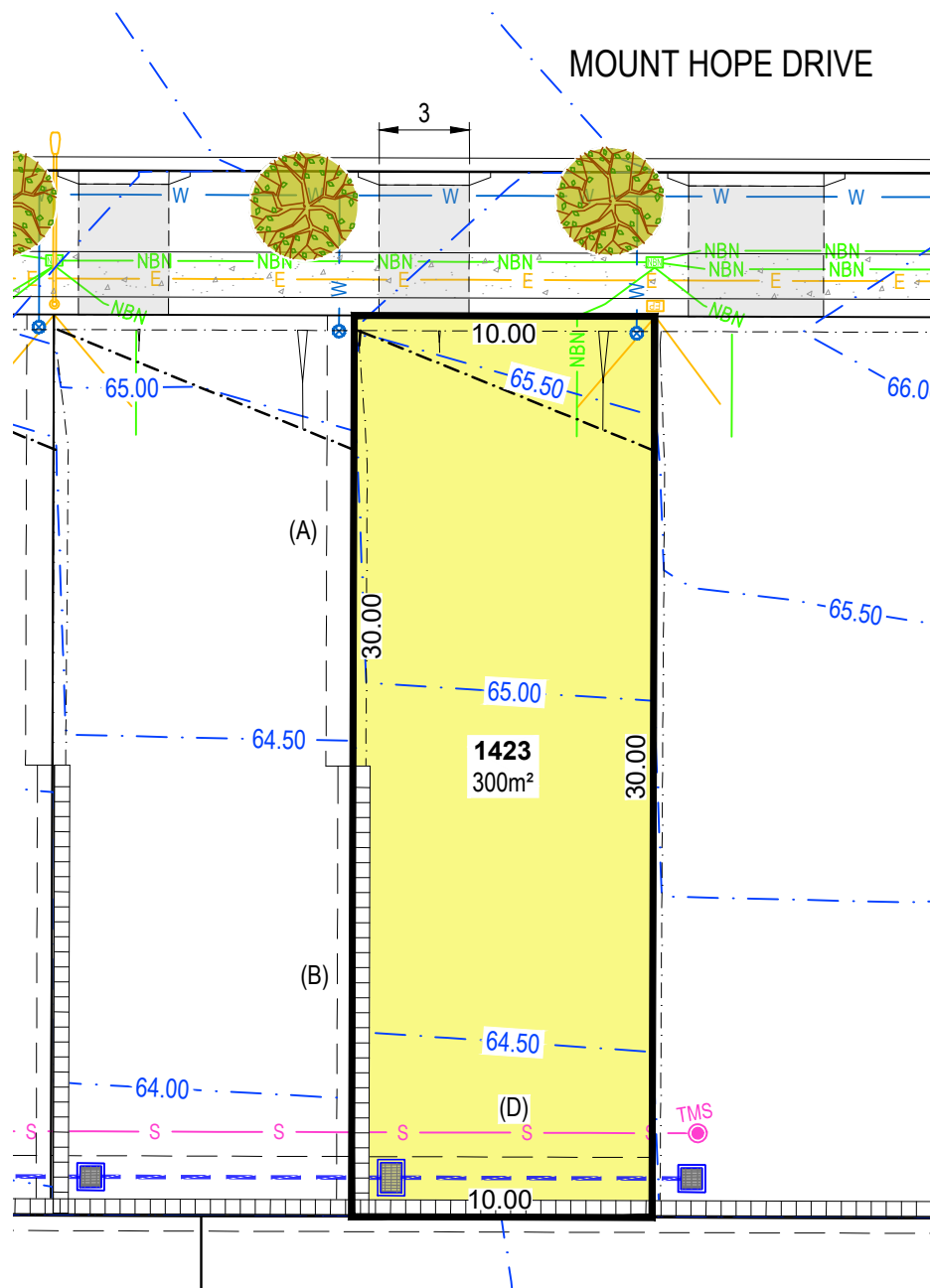

- (A) PROPOSED EASEMENT FOR ACCESS & MAINTENANCE 0.9m WIDE
- (B) PROPOSED EASEMENT FOR RETAINING WALL SUPPORT 0.5m WIDE
- (C) PROPOSED TEMPORARY EASEMENT TO DRAIN WATER 2.5m WIDE
- (D) PROPOSED EASEMENT TO DRAIN WATER 2.0m WIDE
- (H) PROPOSED EASEMENT TO DRAIN WATER 2.7 WIDE & VARIABLE

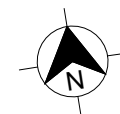

18/03/2026

LEGEND

- | | | | | | |
|----------|----------------------------------|---------|-----------------------------------|---|--|
| --- | EASEMENT FOR DRAINAGE & SERVICES | — E — | ELECTRICITY | ⊙ | SEWER MAINTENANCE CHAMBER, HOLE & TERMINAL MAINTENANCE SHAFT |
| ▤ | RETAINING WALL | — NBN — | COMMUNICATIONS | ⊙ | BATTER |
| — S — | DRAINAGE LINE & PIT | — | STREET LIGHT | — | VEHICULAR CROSSING & DRIVEWAY |
| — S — | SEWER MAIN | ⊙ | ELECTRICAL PILLAR | ⊙ | STREET TREE |
| — W — | WATER MAIN | ⊙ | COMMUNICATIONS PIT | | |
| — 58.0 — | FINISHED SURFACE LEVEL | ⊙ | WATER HYDRANT, STOP VALVE & SCOUR | | |

This plan is provided solely for the purpose of providing an impression of the concept relating to the proposed development called 'Orchard Hills North', as well as the approximate location of existing and proposed third party facilities, services or destinations, and is not intended to be used for any other purpose. Legacy Group does not make any representation or give any warranty in relation to the future development of the site, the staging of any future development or the current or future location or existence of any facilities, services or destinations. The plan is based on the present intention of, and information available to, Legacy Group and the current known requirements of relevant authorities at the time of creation of the plan and details may change due to future circumstances. Any indications of distance or size are approximate and for indicative purposes only and are not to scale. The plan and any matters shown on or inferred from it do not give rise to a legally binding obligation on or representation or warranty by Legacy Group. Legacy Group accepts no liability for any loss or damage arising as a result of any reliance on this plan or its contents. Branding & Marketing by Delivery.net.au



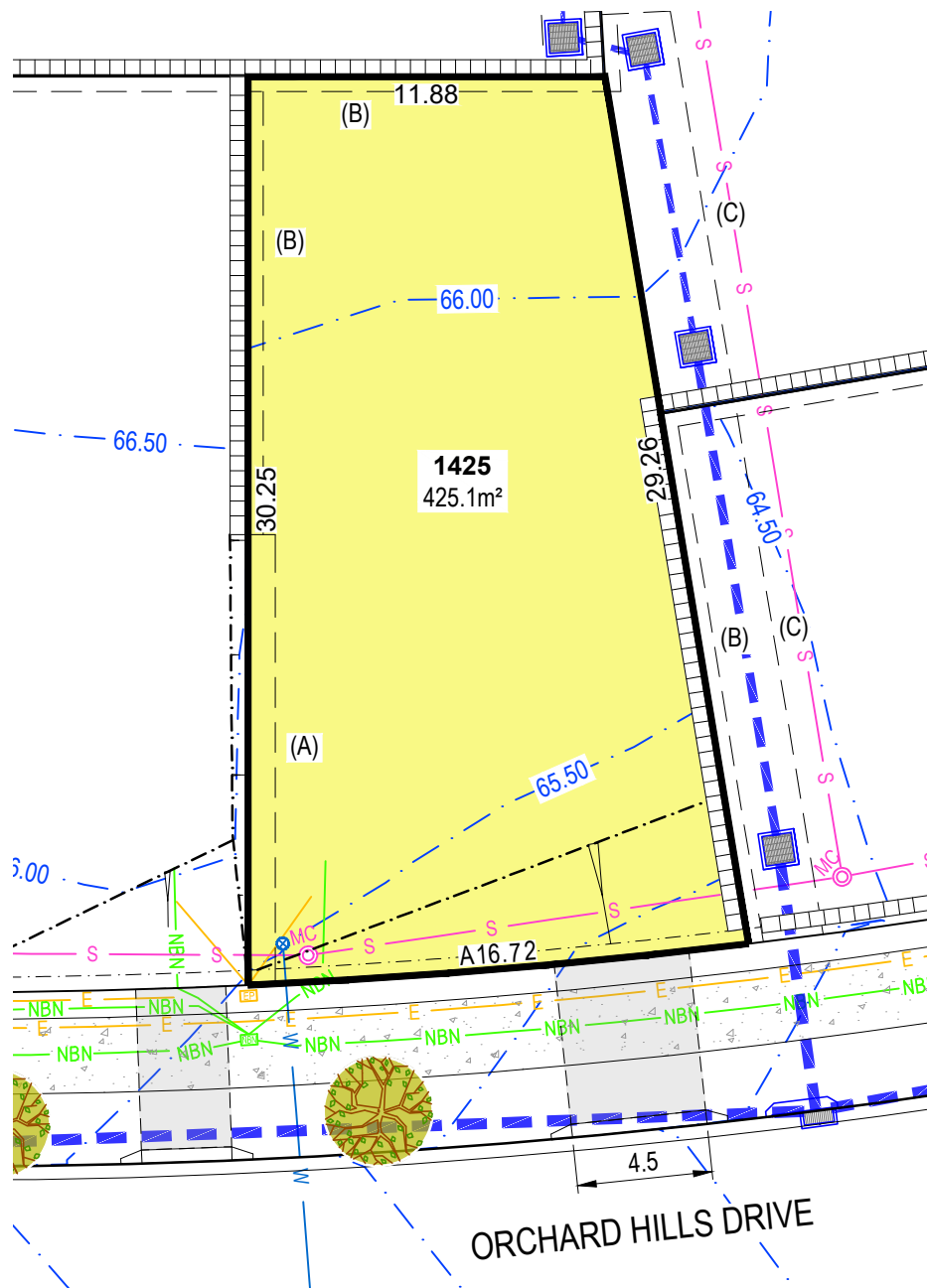

- (B) PROPOSED EASEMENT FOR RETAINING WALL SUPPORT 0.5m WIDE
- (C) PROPOSED EASEMENT TO DRAIN WATER 2.5m WIDE
- (D) PROPOSED EASEMENT TO DRAIN WATER 2.0m WIDE

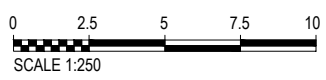

LEGEND

	EASEMENT FOR DRAINAGE & SERVICES		ELECTRICITY		SEWER MAINTENANCE CHAMBER, HOLE & TERMINAL MAINTENANCE SHAFT
	RETAINING WALL		COMMUNICATIONS		BATTER
	DRAINAGE LINE & PIT		STREET LIGHT		VEHICULAR CROSSING & DRIVEWAY
	SEWER MAIN		ELECTRICAL PILLAR		STREET TREE
	WATER MAIN		COMMUNICATIONS PIT		
	FINISHED SURFACE LEVEL		WATER HYDRANT, STOP VALVE & SCOUR		

09/04/2026

This plan is provided solely for the purpose of providing an impression of the concept relating to the proposed development called 'Orchard Hills North', as well as the approximate location of existing and proposed third party facilities, services or destinations, and is not intended to be used for any other purpose. Legacy Group does not make any representation or give any warranty in relation to the future development of the site, the staging of any future development or the current or future location or existence of any facilities, services or destinations. The plan is based on the present intention of, and information available to, Legacy Group and the current known requirements of relevant authorities at the time of creation of the plan and details may change due to future circumstances. Any indications of distance or size are approximate and for indicative purposes only and are not to scale. The plan and any matters shown on or inferred from it do not give rise to a legally binding obligation on or representation or warranty by Legacy Group. Legacy Group accepts no liability for any loss or damage arising as a result of any reliance on this plan or its contents. Branding & Marketing by Delivery.net.au

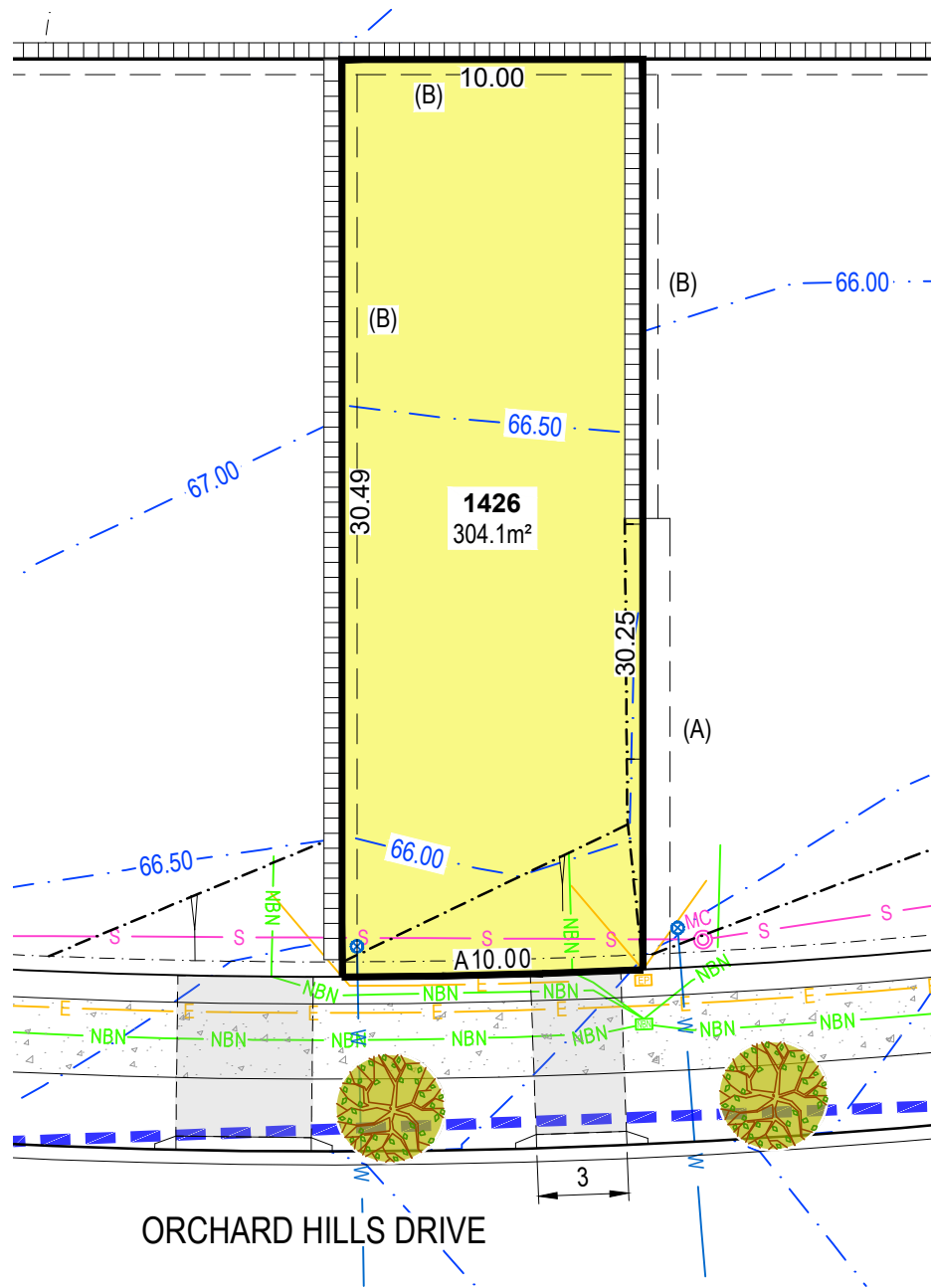

- (A) PROPOSED EASEMENT ACCESS & MAINTENANCE 0.9m WIDE
- (B) PROPOSED EASEMENT FOR RETAINING WALL SUPPORT 0.5m WIDE



LEGEND

- | | | | | | |
|------|----------------------------------|-----|-----------------------------------|---|--|
| --- | EASEMENT FOR DRAINAGE & SERVICES | E | ELECTRICITY | ⊙ | SEWER MAINTENANCE CHAMBER, HOLE & TERMINAL MAINTENANCE SHAFT |
| ▤ | RETAINING WALL | NBN | COMMUNICATIONS | ⊙ | BATTER |
| — | DRAINAGE LINE & PIT | — | STREET LIGHT | — | VEHICULAR CROSSING & DRIVEWAY |
| S | SEWER MAIN | EP | ELECTRICAL PILLAR | — | STREET TREE |
| W | WATER MAIN | NP | COMMUNICATIONS PIT | | |
| 58.0 | FINISHED SURFACE LEVEL | ⊕ | WATER HYDRANT, STOP VALVE & SCOUR | | |

09/04/2026

This plan is provided solely for the purpose of providing an impression of the concept relating to the proposed development called 'Orchard Hills North', as well as the approximate location of existing and proposed third party facilities, services or destinations, and is not intended to be used for any other purpose. Legacy Group does not make any representation or give any warranty in relation to the future development of the site, the staging of any future development or the current or future location or existence of any facilities, services or destinations. The plan is based on the present intention of, and information available to, Legacy Group and the current known requirements of relevant authorities at the time of creation of the plan and details may change due to future circumstances. Any indications of distance or size are approximate and for indicative purposes only and are not to scale. The plan and any matters shown on or inferred from it do not give rise to a legally binding obligation on or representation or warranty by Legacy Group. Legacy Group accepts no liability for any loss or damage arising as a result of any reliance on this plan or its contents. Branding & Marketing by Delivery.net.au

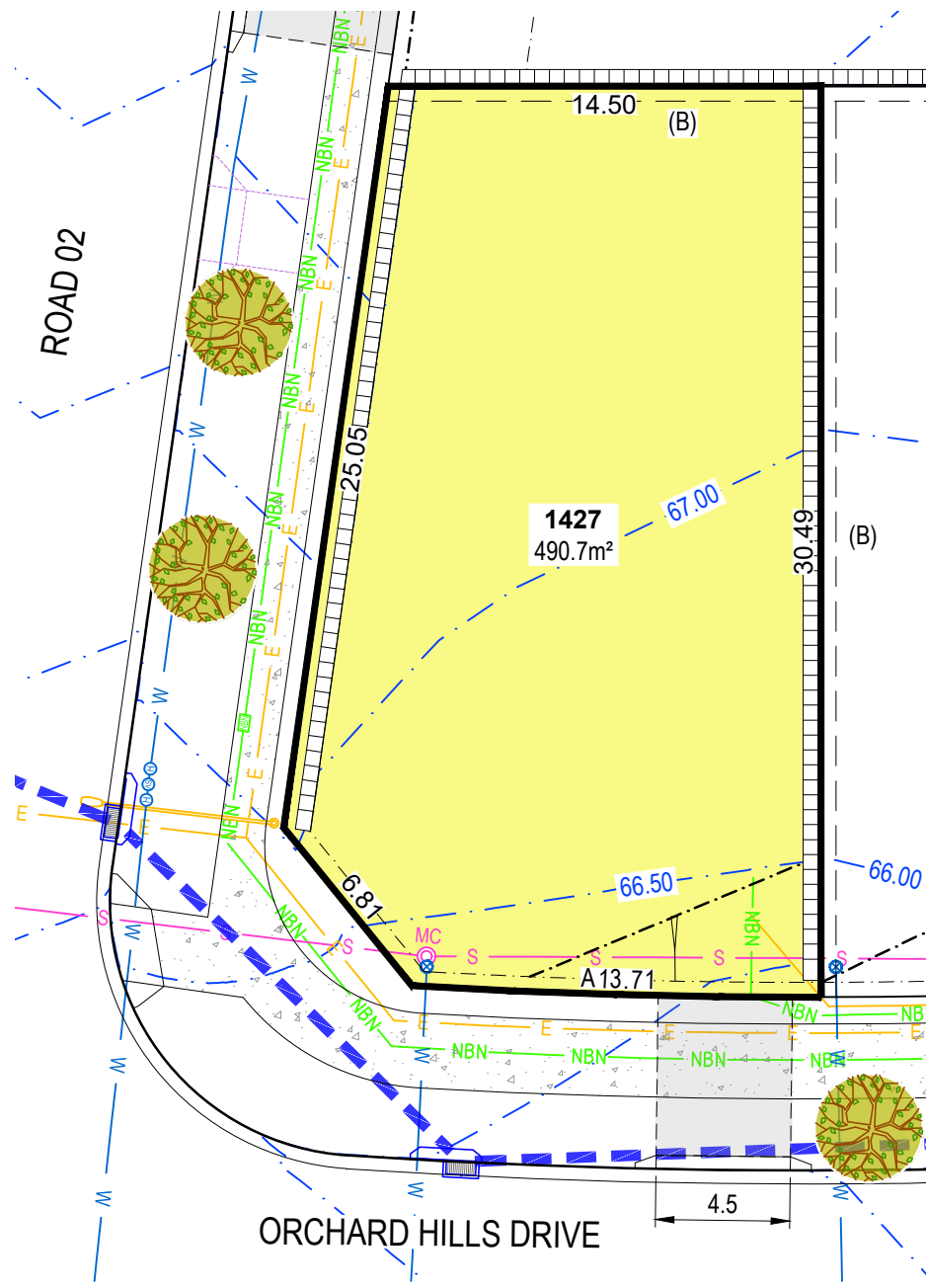

(B) PROPOSED EASEMENT FOR RETAINING WALL SUPPORT 0.5m WIDE



LEGEND

- | | | | | | |
|----------|----------------------------------|---------|-----------------------------------|-------|--|
| --- | EASEMENT FOR DRAINAGE & SERVICES | — E — | ELECTRICITY | ⊙ ⊙ ⊙ | SEWER MAINTENANCE CHAMBER, HOLE & TERMINAL MAINTENANCE SHAFT |
| ▬▬▬▬▬▬ | RETAINING WALL | — NBN — | COMMUNICATIONS | ⊙ | BATTER |
| — S — | DRAINAGE LINE & PIT | — | STREET LIGHT | ⊙ | VEHICULAR CROSSING & DRIVEWAY |
| — W — | SEWER MAIN | ⊙ | ELECTRICAL PILLAR | ⊙ | STREET TREE |
| — 58.0 — | WATER MAIN | ⊙ | COMMUNICATIONS PIT | | |
| — 58.0 — | FINISHED SURFACE LEVEL | ⊙ | WATER HYDRANT, STOP VALVE & SCOUR | | |

09/04/2026

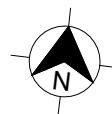

This plan is provided solely for the purpose of providing an impression of the concept relating to the proposed development called 'Orchard Hills North', as well as the approximate location of existing and proposed third party facilities, services or destinations, and is not intended to be used for any other purpose. Legacy Group does not make any representation or give any warranty in relation to the future development of the site, the staging of any future development or the current or future location or existence of any facilities, services or destinations. The plan is based on the present intention of, and information available to, Legacy Group and the current known requirements of relevant authorities at the time of creation of the plan and details may change due to future circumstances. Any indications of distance or size are approximate and for indicative purposes only and are not to scale. The plan and any matters shown on or inferred from it do not give rise to a legally binding obligation on or representation or warranty by Legacy Group. Legacy Group accepts no liability for any loss or damage arising as a result of any reliance on this plan or its contents. Branding & Marketing by Delivery.net.au



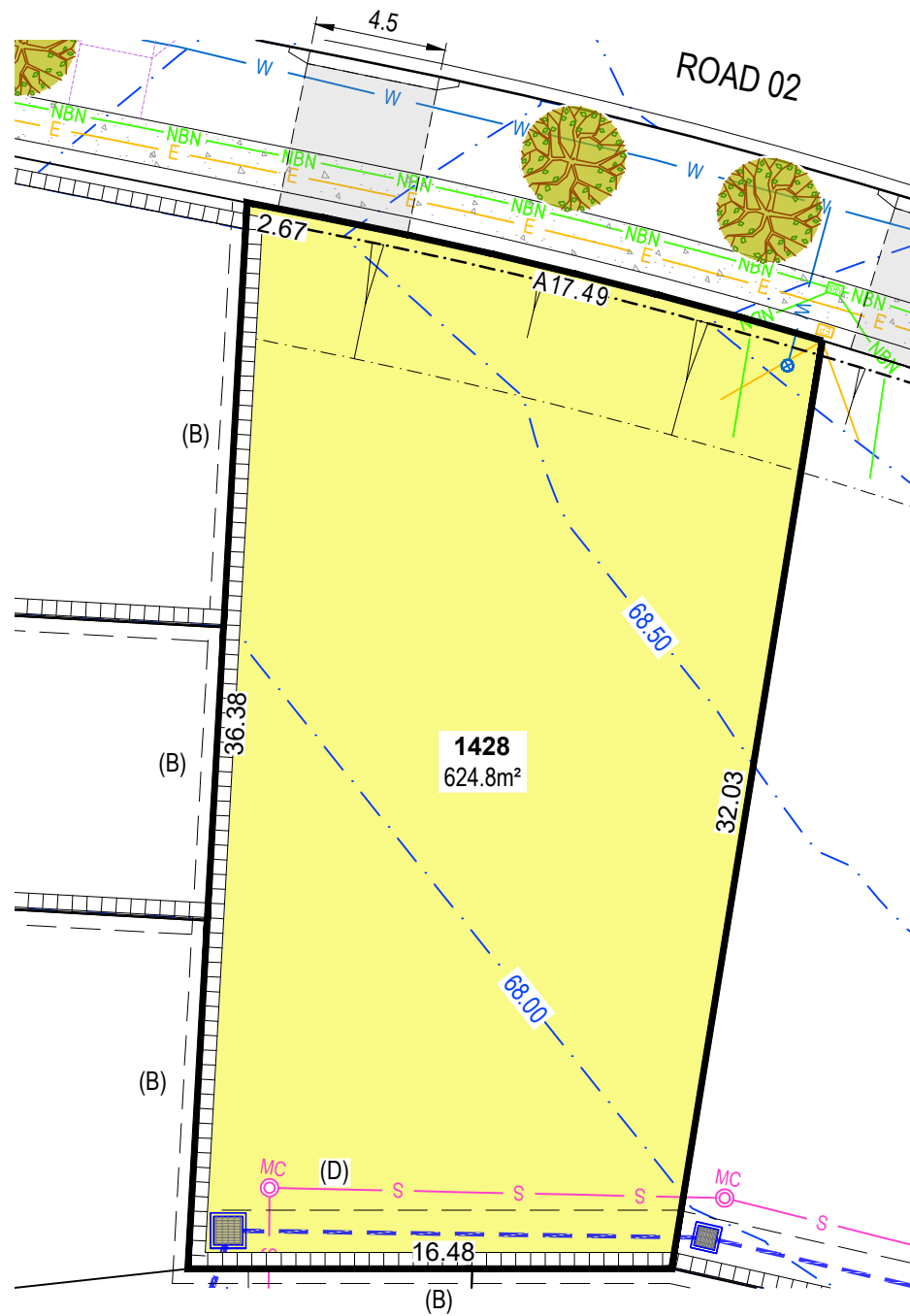

(B) PROPOSED EASEMENT FOR RETAINING WALL SUPPORT 0.5m WIDE

(D) PROPOSED EASEMENT TO DRAIN WATER 2.0m WIDE



LEGEND

- | | | | | | |
|----------|----------------------------------|---------|-----------------------------------|-------|--|
| --- | EASEMENT FOR DRAINAGE & SERVICES | — E — | ELECTRICITY | ⊙ ⊠ ⊙ | SEWER MAINTENANCE CHAMBER, HOLE & TERMINAL MAINTENANCE SHAFT |
| ▤ | RETAINING WALL | — NBN — | COMMUNICATIONS | ⊙ | BATTER |
| — S — | SEWER MAIN | — | STREET LIGHT | — | VEHICULAR CROSSING & DRIVEWAY |
| — W — | WATER MAIN | ⊠ | ELECTRICAL PILLAR | — | STREET TREE |
| — 58.0 — | FINISHED SURFACE LEVEL | ⊠ | COMMUNICATIONS PIT | | |
| | | ⊙ ⊠ ⊙ | WATER HYDRANT, STOP VALVE & SCOUR | | |

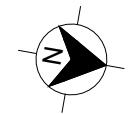

09/04/2026

This plan is provided solely for the purpose of providing an impression of the concept relating to the proposed development called 'Orchard Hills North', as well as the approximate location of existing and proposed third party facilities, services or destinations, and is not intended to be used for any other purpose. Legacy Group does not make any representation or give any warranty in relation to the future development of the site, the staging of any future development or the current or future location or existence of any facilities, services or destinations. The plan is based on the present intention of, and information available to, Legacy Group and the current known requirements of relevant authorities at the time of creation of the plan and details may change due to future circumstances. Any indications of distance or size are approximate and for indicative purposes only and are not to scale. The plan and any matters shown on or inferred from it do not give rise to a legally binding obligation or representation or warranty by Legacy Group. Legacy Group accepts no liability for any loss or damage arising as a result of any reliance on this plan or its contents. Branding & Marketing by Delivery.net.au



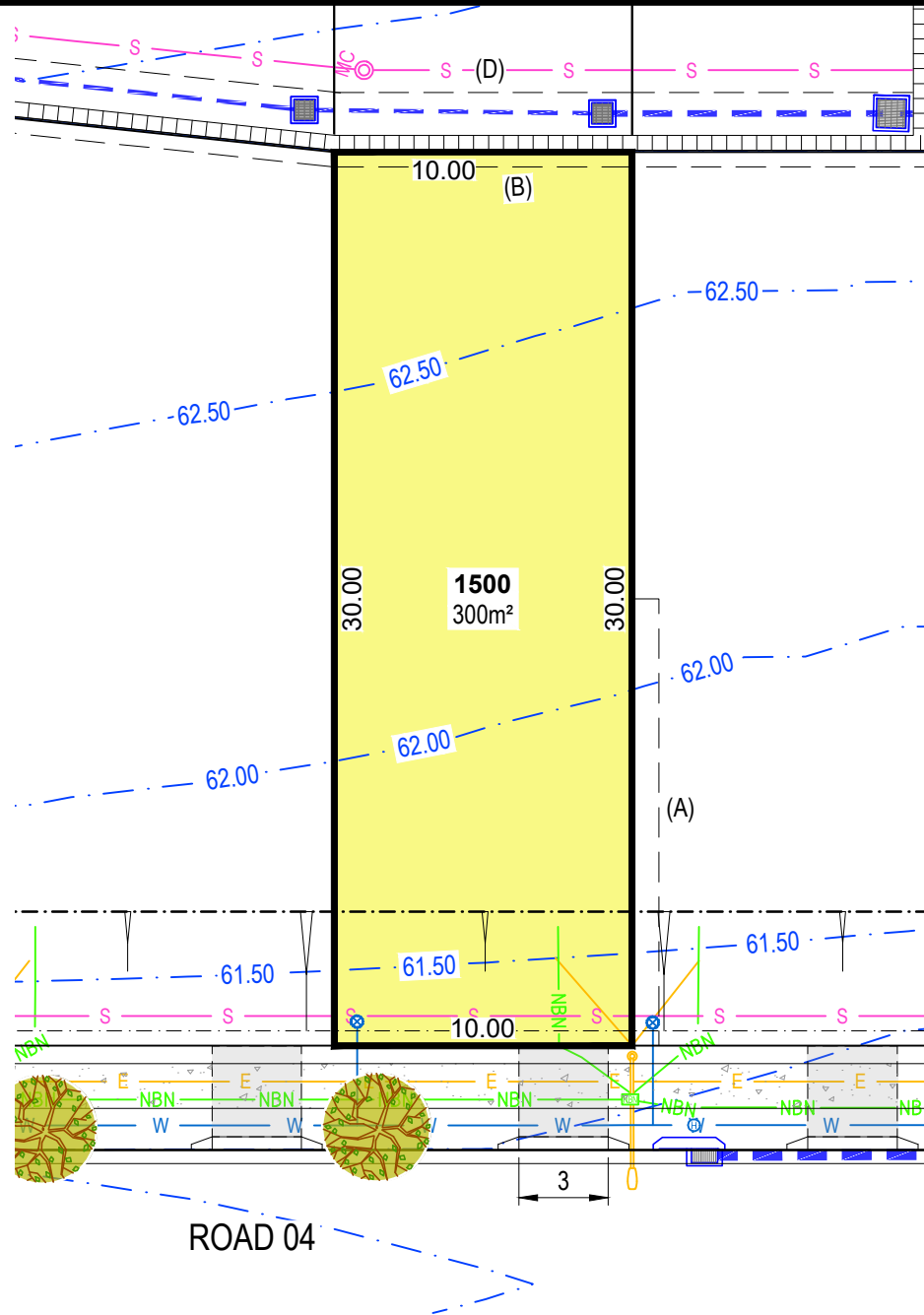

- (A) PROPOSED EASEMENT FOR ACCESS & MAINTENANCE 0.9m WIDE
- (B) PROPOSED EASEMENT FOR RETAINING WALL SUPPORT 0.5m WIDE
- (D) PROPOSED EASEMENT TO DRAIN WATER 2.0m WIDE



LEGEND

	EASEMENT FOR DRAINAGE & SERVICES		ELECTRICITY		SEWER MAINTENANCE CHAMBER, HOLE & TERMINAL MAINTENANCE SHAFT
	RETAINING WALL		COMMUNICATIONS		BATTER
	DRAINAGE LINE & PIT		STREET LIGHT		VEHICULAR CROSSING & DRIVEWAY
	SEWER MAIN		ELECTRICAL PILLAR		STREET TREE
	WATER MAIN		COMMUNICATIONS PIT		
	FINISHED SURFACE LEVEL		WATER HYDRANT, STOP VALVE & SCOUR		

09/04/2026

This plan is provided solely for the purpose of providing an impression of the concept relating to the proposed development called 'Orchard Hills North', as well as the approximate location of existing and proposed third party facilities, services or destinations, and is not intended to be used for any other purpose. Legacy Group does not make any representation or give any warranty in relation to the future development of the site, the staging of any future development or the current or future location or existence of any facilities, services or destinations. The plan is based on the present intention of, and information available to, Legacy Group and the current known requirements of relevant authorities at the time of creation of the plan and details may change due to future circumstances. Any indications of distance or size are approximate and for indicative purposes only and are not to scale. The plan and any matters shown on or inferred from it do not give rise to a legally binding obligation on or representation or warranty by Legacy Group. Legacy Group accepts no liability for any loss or damage arising as a result of any reliance on this plan or its contents. Branding & Marketing by Delivery.net.au

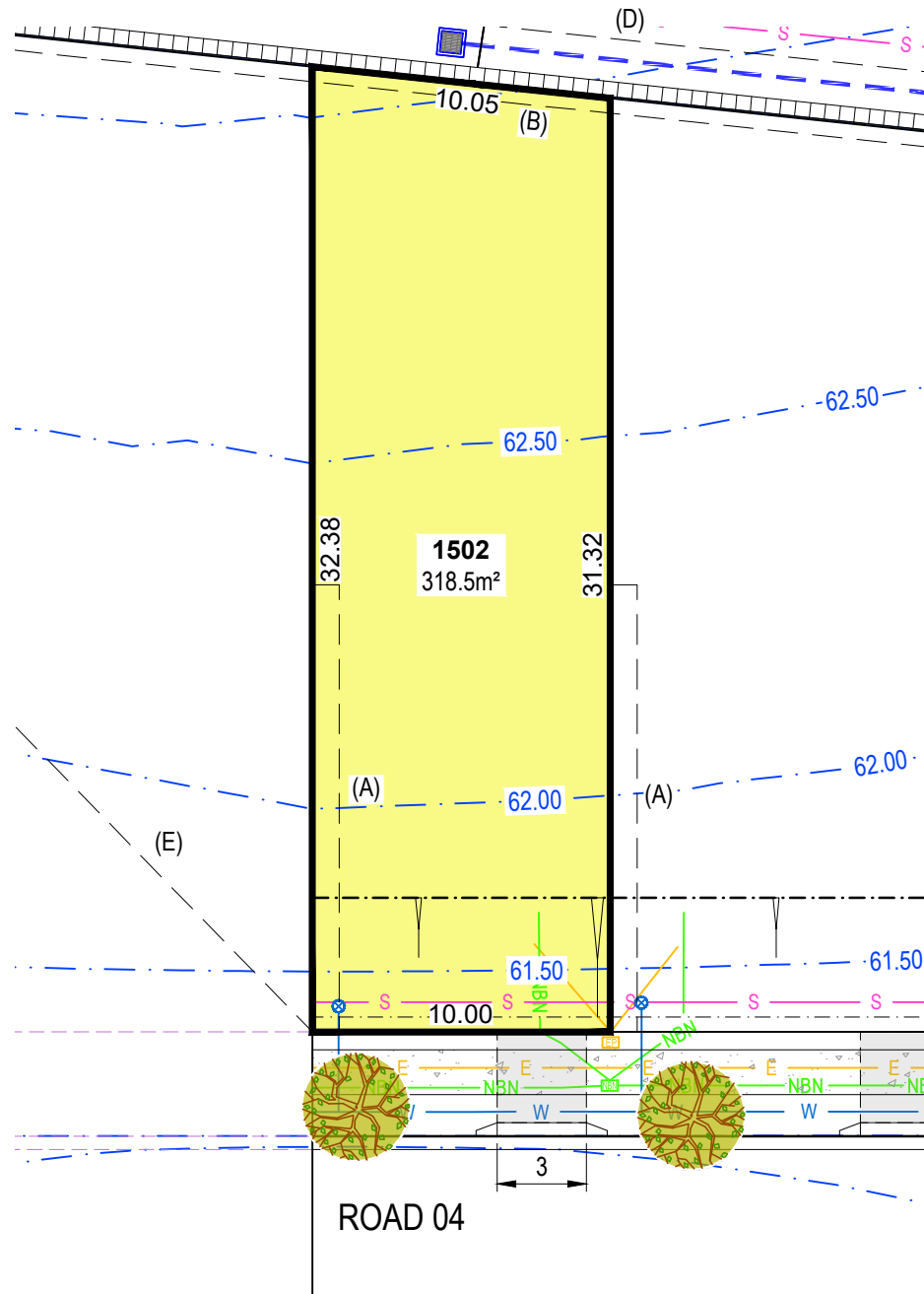

- (A) PROPOSED EASEMENT FOR ACCESS & MAINTENANCE 0.9m WIDE
- (B) PROPOSED EASEMENT FOR RETAINING WALL SUPPORT 0.5m WIDE
- (D) PROPOSED EASEMENT TO DRAIN WATER 2.0m WIDE
- (E) PROPOSED TEMPORARY RIGHT OF CARRIAGEWAY VARIABLE WIDTH



LEGEND

- | | | | | | |
|----------|----------------------------------|---------|-----------------------------------|---|--|
| --- | EASEMENT FOR DRAINAGE & SERVICES | — E — | ELECTRICITY | ⊙ | SEWER MAINTENANCE CHAMBER, HOLE & TERMINAL MAINTENANCE SHAFT |
| ▤ | RETAINING WALL | — NBN — | COMMUNICATIONS | ⊙ | BATTER |
| — S — | DRAINAGE LINE & PIT | — | STREET LIGHT | ⊙ | VEHICULAR CROSSING & DRIVEWAY |
| — W — | SEWER MAIN | ⊙ | ELECTRICAL PILLAR | ⊙ | STREET TREE |
| — 58.0 — | WATER MAIN | ⊙ | COMMUNICATIONS PIT | | |
| — 58.0 — | FINISHED SURFACE LEVEL | ⊙ | WATER HYDRANT, STOP VALVE & SCOUR | | |

09/04/2026

This plan is provided solely for the purpose of providing an impression of the concept relating to the proposed development called 'Orchard Hills North', as well as the approximate location of existing and proposed third party facilities, services or destinations, and is not intended to be used for any other purpose. Legacy Group does not make any representation or give any warranty in relation to the future development of the site, the staging of any future development or the current or future location or existence of any facilities, services or destinations. The plan is based on the present intention of, and information available to, Legacy Group and the current known requirements of relevant authorities at the time of creation of the plan and details may change due to future circumstances. Any indications of distance or size are approximate and for indicative purposes only and are not to scale. The plan and any matters shown on or inferred from it do not give rise to a legally binding obligation on or representation or warranty by Legacy Group. Legacy Group accepts no liability for any loss or damage arising as a result of any reliance on this plan or its contents. Branding & Marketing by Delivery.net.au



MOUNT HOPE DRIVE

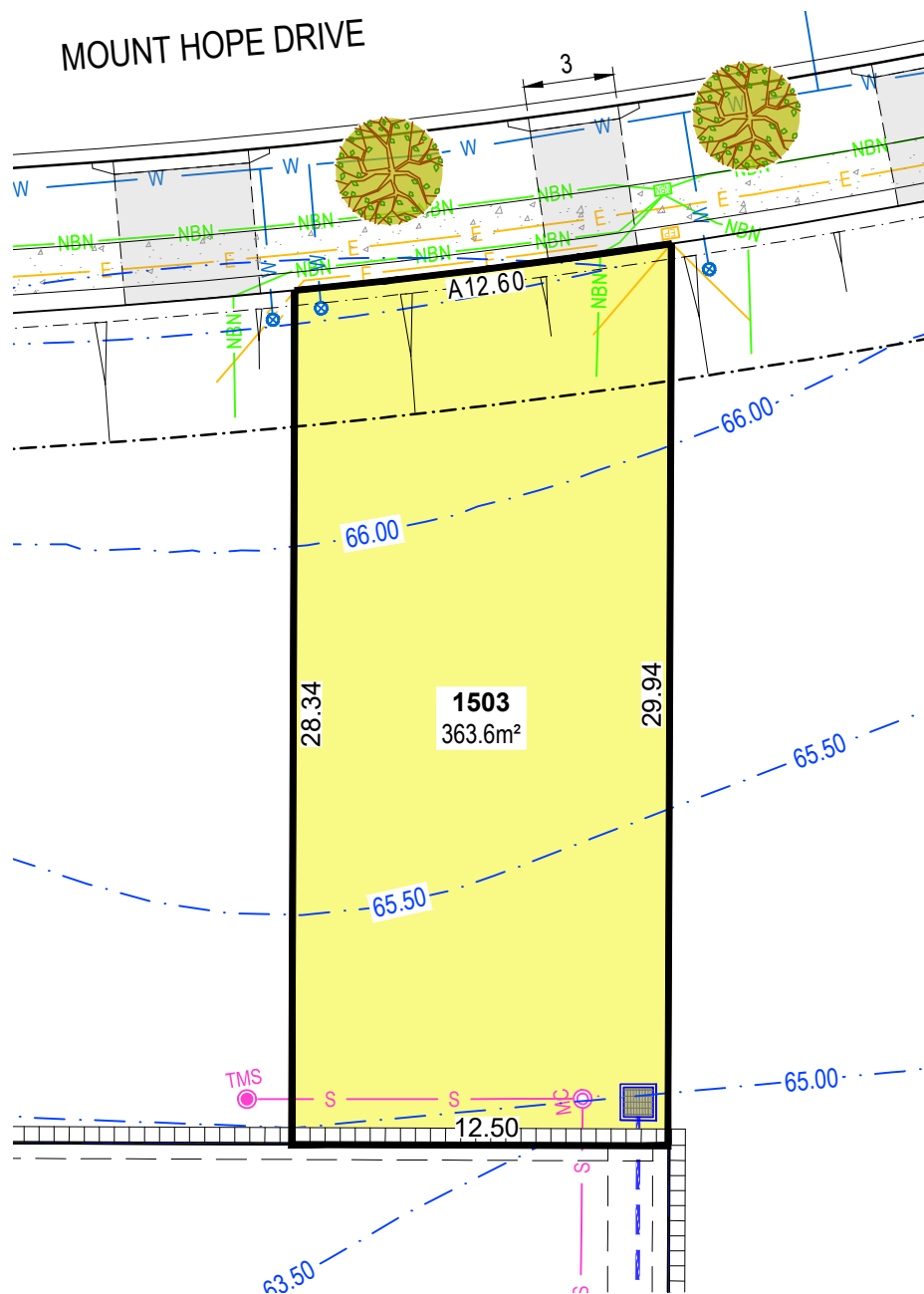

- (A) PROPOSED EASEMENT FOR ACCESS & MAINTENANCE 0.9m WIDE
- (B) PROPOSED EASEMENT FOR RETAINING WALL SUPPORT 0.5m WIDE
- (C) PROPOSED TEMPORARY EASEMENT TO DRAIN WATER 2.5m WIDE
- (D) PROPOSED EASEMENT TO DRAIN WATER 2.0m WIDE
- (H) PROPOSED EASEMENT TO DRAIN WATER 2.7 WIDE & VARIABLE

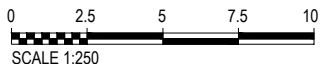

LEGEND

	EASEMENT FOR DRAINAGE & SERVICES		ELECTRICITY		SEWER MAINTENANCE CHAMBER, HOLE & TERMINAL MAINTENANCE SHAFT
	RETAINING WALL		COMMUNICATIONS		BATTER
	DRAINAGE LINE & PIT		STREET LIGHT		VEHICULAR CROSSING & DRIVEWAY
	SEWER MAIN		ELECTRICAL PILLAR		STREET TREE
	WATER MAIN		COMMUNICATIONS PIT		
	FINISHED SURFACE LEVEL		WATER HYDRANT, STOP VALVE & SCOUR		

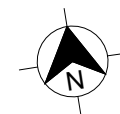

18/03/2026

This plan is provided solely for the purpose of providing an impression of the concept relating to the proposed development called 'Orchard Hills North', as well as the approximate location of existing and proposed third party facilities, services or destinations, and is not intended to be used for any other purpose. Legacy Group does not make any representation or give any warranty in relation to the future development of the site, the staging of any future development or the current or future location or existence of any facilities, services or destinations. The plan is based on the present intention of, and information available to, Legacy Group and the current known requirements of relevant authorities at the time of creation of the plan and details may change due to future circumstances. Any indications of distance or size are approximate and for indicative purposes only and are not to scale. The plan and any matters shown on or inferred from it do not give rise to a legally binding obligation on or representation or warranty by Legacy Group. Legacy Group accepts no liability for any loss or damage arising as a result of any reliance on this plan or its contents. Branding & Marketing by Delivery.net.au



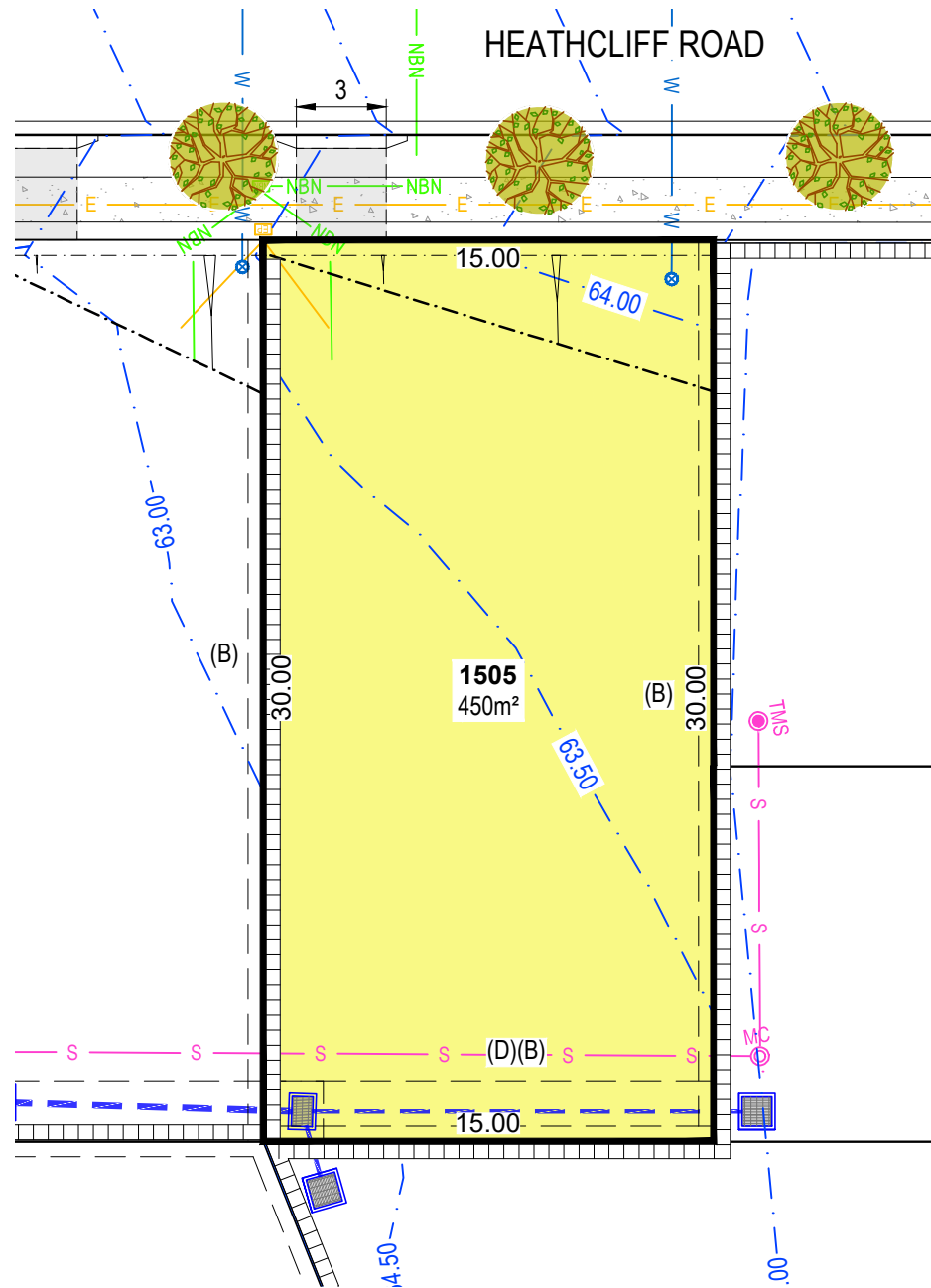

- (A) PROPOSED EASEMENT FOR ACCESS & MAINTENANCE 0.9m WIDE
- (B) PROPOSED EASEMENT FOR RETAINING WALL SUPPORT 0.5m WIDE
- (C) PROPOSED TEMPORARY EASEMENT TO DRAIN WATER 2.5m WIDE
- (D) PROPOSED EASEMENT TO DRAIN WATER 2.0m WIDE
- (H) PROPOSED EASEMENT TO DRAIN WATER 2.7 WIDE & VARIABLE



LEGEND

- | | | | | | |
|----------|----------------------------------|---------|-----------------------------------|-------|--|
| --- | EASEMENT FOR DRAINAGE & SERVICES | — E — | ELECTRICITY | ⊙ ⊙ ⊙ | SEWER MAINTENANCE CHAMBER, HOLE & TERMINAL MAINTENANCE SHAFT |
| ▤ | RETAINING WALL | — NBN — | COMMUNICATIONS | ⊙ | BATTER |
| — W — | DRAINAGE LINE & PIT | ⊙ | STREET LIGHT | — S — | VEHICULAR CROSSING & DRIVEWAY |
| — S — | SEWER MAIN | ⊙ | ELECTRICAL PILLAR | ⊙ | STREET TREE |
| — W — | WATER MAIN | ⊙ | COMMUNICATIONS PIT | | |
| — 58.0 — | FINISHED SURFACE LEVEL | ⊙ | WATER HYDRANT, STOP VALVE & SCOUR | | |

18/03/2026

This plan is provided solely for the purpose of providing an impression of the concept relating to the proposed development called 'Orchard Hills North', as well as the approximate location of existing and proposed third party facilities, services or destinations, and is not intended to be used for any other purpose. Legacy Group does not make any representation or give any warranty in relation to the future development of the site, the staging of any future development or the current or future location or existence of any facilities, services or destinations. The plan is based on the present intention of, and information available to, Legacy Group and the current known requirements of relevant authorities at the time of creation of the plan and details may change due to future circumstances. Any indications of distance or size are approximate and for indicative purposes only and are not to scale. The plan and any matters shown on or inferred from it do not give rise to a legally binding obligation on or representation or warranty by Legacy Group. Legacy Group accepts no liability for any loss or damage arising as a result of any reliance on this plan or its contents. Branding & Marketing by Delivery.net.au

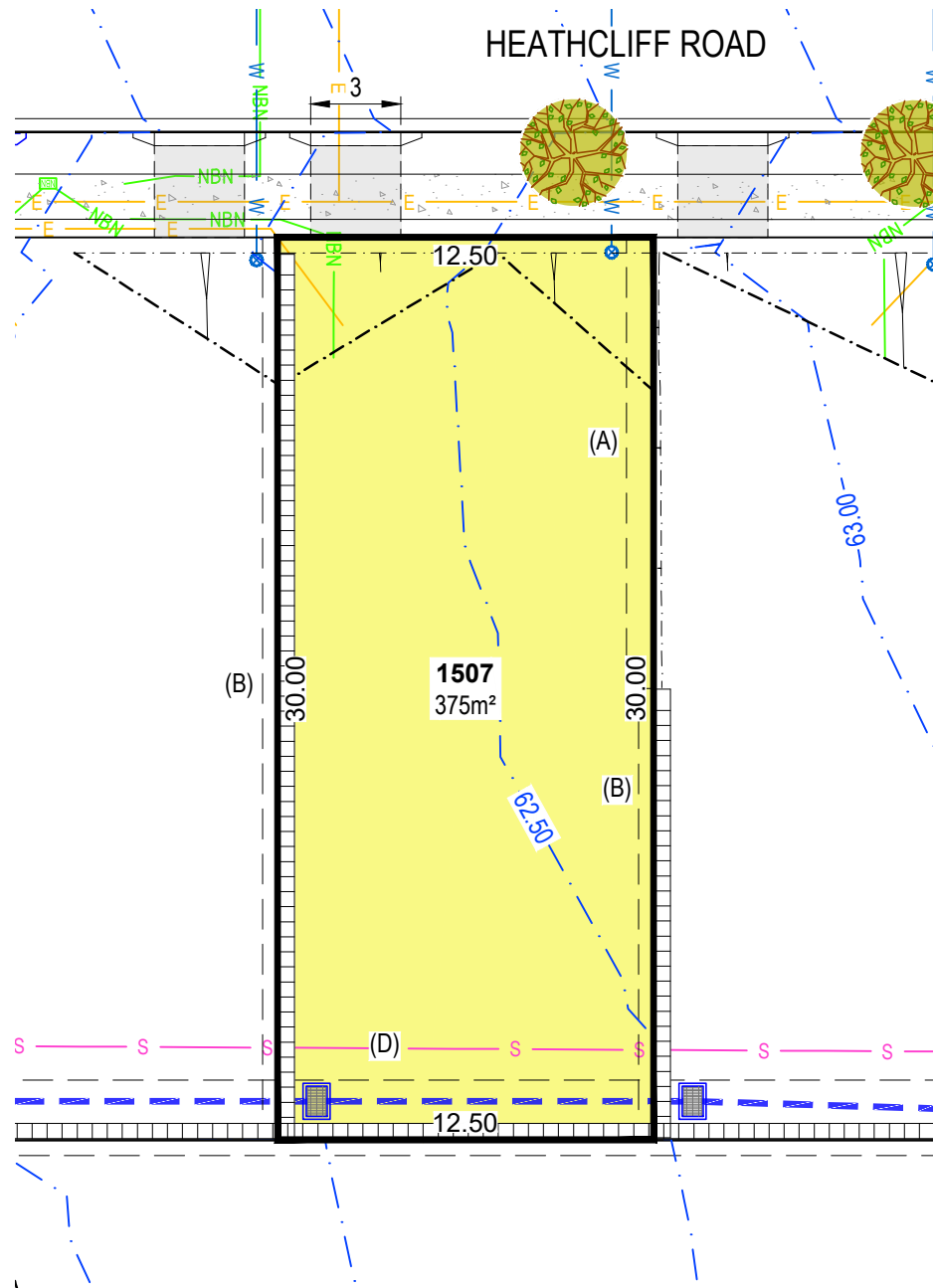

- (A) PROPOSED EASEMENT FOR ACCESS & MAINTENANCE 0.9m WIDE
- (B) PROPOSED EASEMENT FOR RETAINING WALL SUPPORT 0.5m WIDE
- (C) PROPOSED TEMPORARY EASEMENT TO DRAIN WATER 2.5m WIDE
- (D) PROPOSED EASEMENT TO DRAIN WATER 2.0m WIDE
- (H) PROPOSED EASEMENT TO DRAIN WATER 2.7 WIDE & VARIABLE



LEGEND

- | | | | | | |
|----------|----------------------------------|---------|-----------------------------------|-------|--|
| --- | EASEMENT FOR DRAINAGE & SERVICES | — E — | ELECTRICITY | ⊙ ⊞ ⊙ | SEWER MAINTENANCE CHAMBER, HOLE & TERMINAL MAINTENANCE SHAFT |
| ▤ | RETAINING WALL | — NBN — | COMMUNICATIONS | ⊙ | BATTER |
| — S — | DRAINAGE LINE & PIT | — | STREET LIGHT | — | VEHICULAR CROSSING & DRIVEWAY |
| — W — | SEWER MAIN | ⊞ | ELECTRICAL PILLAR | ⊙ | STREET TREE |
| — 58.0 — | WATER MAIN | ⊞ | COMMUNICATIONS PIT | | |
| — 58.0 — | FINISHED SURFACE LEVEL | ⊞ | WATER HYDRANT, STOP VALVE & SCOUR | | |

18/03/2026

This plan is provided solely for the purpose of providing an impression of the concept relating to the proposed development called 'Orchard Hills North', as well as the approximate location of existing and proposed third party facilities, services or destinations, and is not intended to be used for any other purpose. Legacy Group does not make any representation or give any warranty in relation to the future development of the site, the staging of any future development or the current or future location or existence of any facilities, services or destinations. The plan is based on the present intention of, and information available to, Legacy Group and the current known requirements of relevant authorities at the time of creation of the plan and details may change due to future circumstances. Any indications of distance or size are approximate and for indicative purposes only and are not to scale. The plan and any matters shown on or inferred from it do not give rise to a legally binding obligation on or representation or warranty by Legacy Group. Legacy Group accepts no liability for any loss or damage arising as a result of any reliance on this plan or its contents. Branding & Marketing by Delivery.net.au

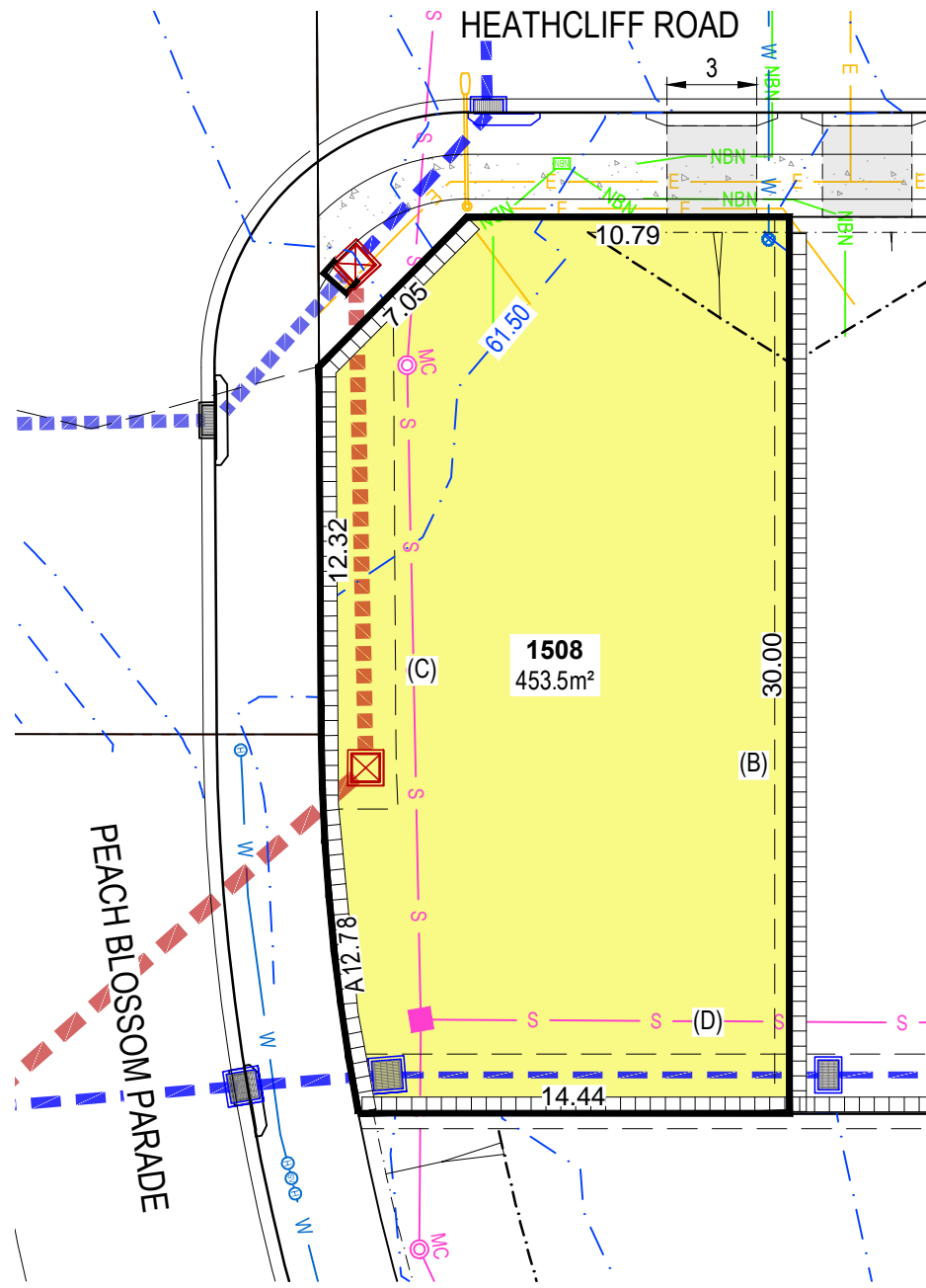

- (A) PROPOSED EASEMENT FOR ACCESS & MAINTENANCE 0.9m WIDE
- (B) PROPOSED EASEMENT FOR RETAINING WALL SUPPORT 0.5m WIDE
- (C) PROPOSED TEMPORARY EASEMENT TO DRAIN WATER 2.5m WIDE
- (D) PROPOSED EASEMENT TO DRAIN WATER 2.0m WIDE
- (H) PROPOSED EASEMENT TO DRAIN WATER 2.7 WIDE & VARIABLE

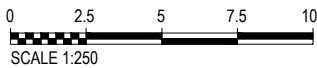

LEGEND

- | | | | | | |
|----------|----------------------------------|---------|-----------------------------------|---------|--|
| --- | EASEMENT FOR DRAINAGE & SERVICES | — E — | ELECTRICITY | ⊙ | SEWER MAINTENANCE CHAMBER, HOLE & TERMINAL MAINTENANCE SHAFT |
| ▬▬▬▬▬▬ | RETAINING WALL | — NBN — | COMMUNICATIONS | ⊙ | BATTER |
| — [] — | DRAINAGE LINE & PIT | — [] — | STREET LIGHT | — [] — | VEHICULAR CROSSING & DRIVEWAY |
| — S — | SEWER MAIN | [] | ELECTRICAL PILLAR | ⊙ | STREET TREE |
| — W — | WATER MAIN | [] | COMMUNICATIONS PIT | | |
| — 58.0 — | FINISHED SURFACE LEVEL | [] | WATER HYDRANT, STOP VALVE & SCOUR | | |

18/03/2026

This plan is provided solely for the purpose of providing an impression of the concept relating to the proposed development called 'Orchard Hills North', as well as the approximate location of existing and proposed third party facilities, services or destinations, and is not intended to be used for any other purpose. Legacy Group does not make any representation or give any warranty in relation to the future development of the site, the staging of any future development or the current or future location or existence of any facilities, services or destinations. The plan is based on the present intention of, and information available to, Legacy Group and the current known requirements of relevant authorities at the time of creation of the plan and details may change due to future circumstances. Any indications of distance or size are approximate and for indicative purposes only and are not to scale. The plan and any matters shown on or inferred from it do not give rise to a legally binding obligation on or representation or warranty by Legacy Group. Legacy Group accepts no liability for any loss or damage arising as a result of any reliance on this plan or its contents. Branding & Marketing by Delivery.net.au



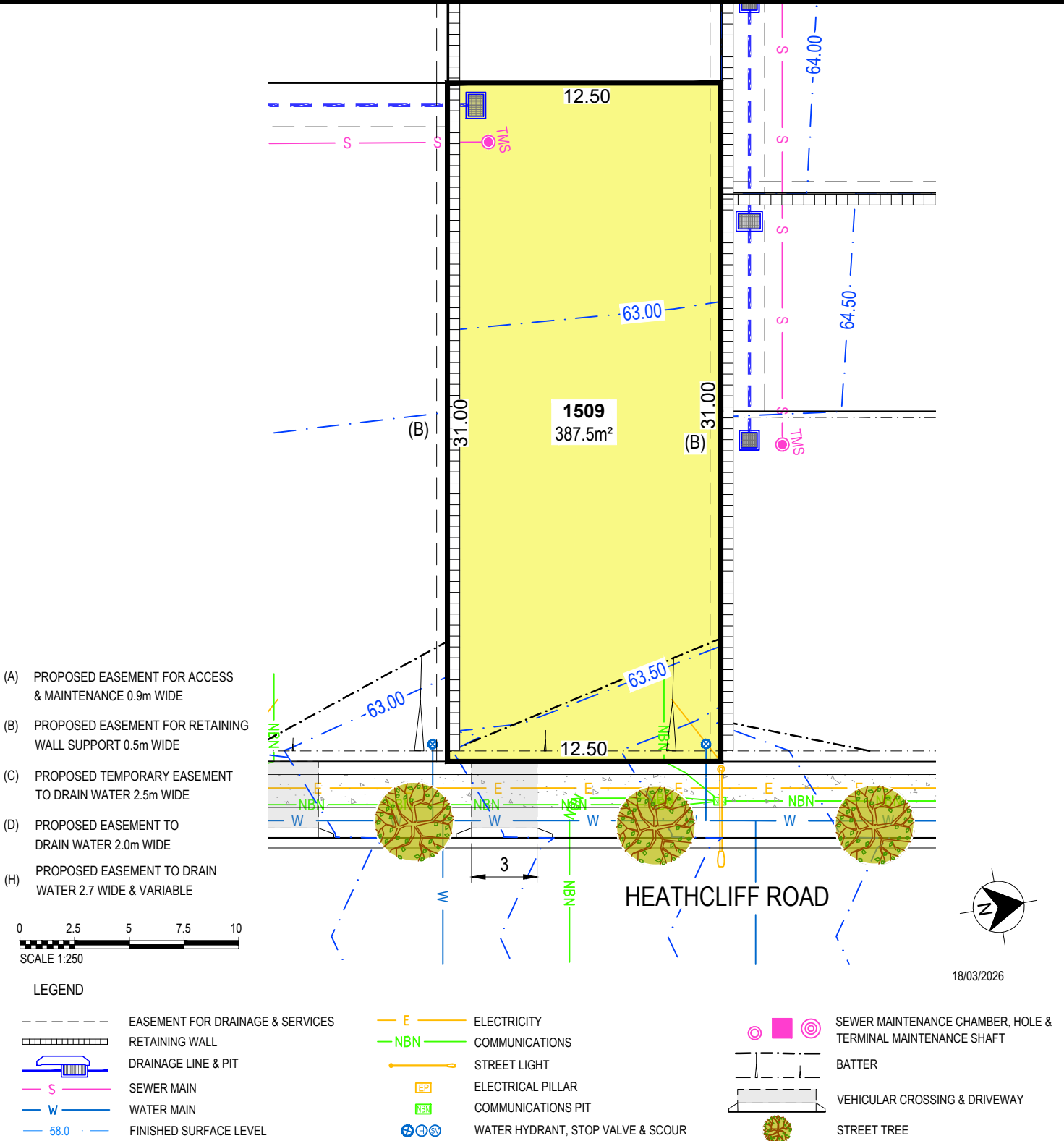

18/03/2026

This plan is provided solely for the purpose of providing an impression of the concept relating to the proposed development called 'Orchard Hills North', as well as the approximate location of existing and proposed third party facilities, services or destinations, and is not intended to be used for any other purpose. Legacy Group does not make any representation or give any warranty in relation to the future development of the site, the staging of any future development or the current or future location or existence of any facilities, services or destinations. The plan is based on the present intention of, and information available to, Legacy Group and the current known requirements of relevant authorities at the time of creation of the plan and details may change due to future circumstances. Any indications of distance or size are approximate and for indicative purposes only and are not to scale. The plan and any matters shown on or inferred from it do not give rise to a legally binding obligation on or representation or warranty by Legacy Group. Legacy Group accepts no liability for any loss or damage arising as a result of any reliance on this plan or its contents. Branding & Marketing by Delivery.net.au



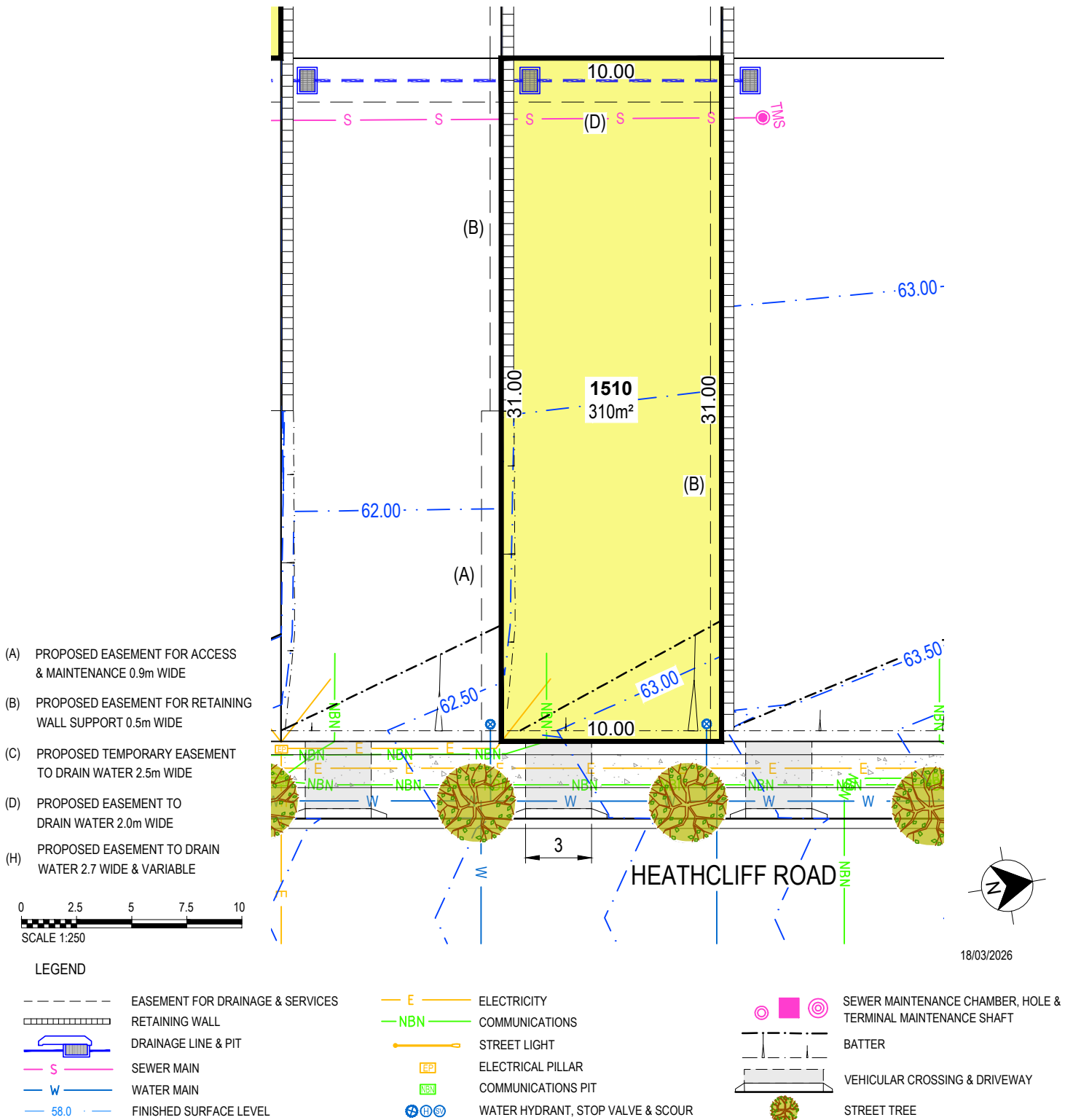

18/03/2026

This plan is provided solely for the purpose of providing an impression of the concept relating to the proposed development called 'Orchard Hills North', as well as the approximate location of existing and proposed third party facilities, services or destinations, and is not intended to be used for any other purpose. Legacy Group does not make any representation or give any warranty in relation to the future development of the site, the staging of any future development or the current or future location or existence of any facilities, services or destinations. The plan is based on the present intention of, and information available to, Legacy Group and the current known requirements of relevant authorities at the time of creation of the plan and details may change due to future circumstances. Any indications of distance or size are approximate and for indicative purposes only and are not to scale. The plan and any matters shown on or inferred from it do not give rise to a legally binding obligation on or representation or warranty by Legacy Group. Legacy Group accepts no liability for any loss or damage arising as a result of any reliance on this plan or its contents. Branding & Marketing by Delivery.net.au



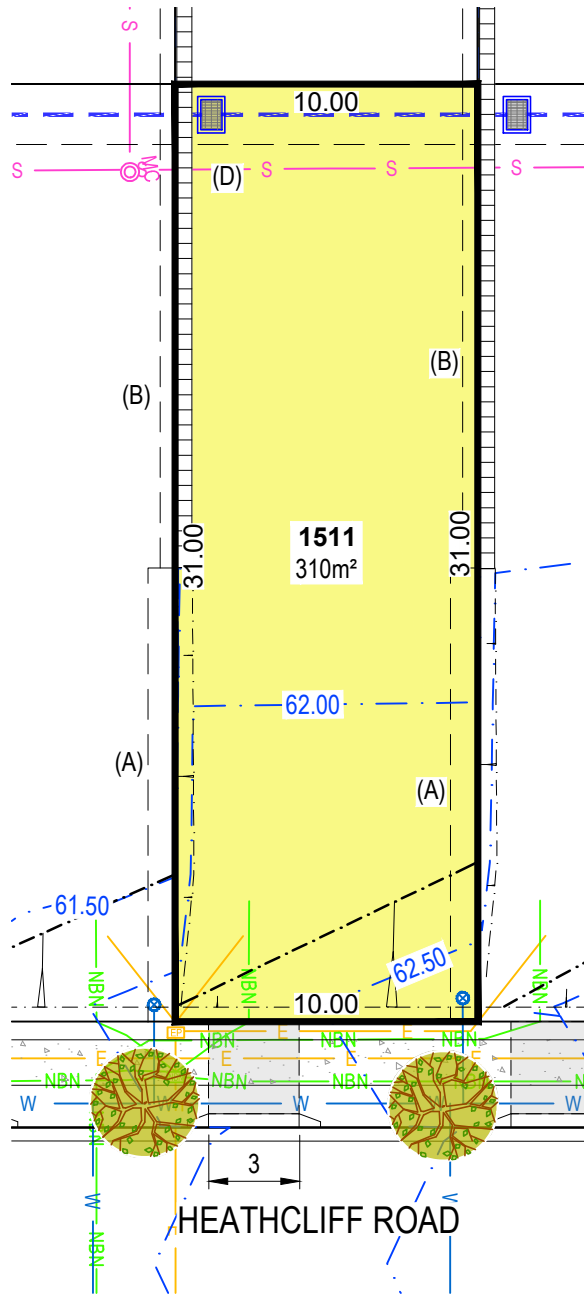

- (A) PROPOSED EASEMENT FOR ACCESS & MAINTENANCE 0.9m WIDE
- (B) PROPOSED EASEMENT FOR RETAINING WALL SUPPORT 0.5m WIDE
- (C) PROPOSED TEMPORARY EASEMENT TO DRAIN WATER 2.5m WIDE
- (D) PROPOSED EASEMENT TO DRAIN WATER 2.0m WIDE
- (H) PROPOSED EASEMENT TO DRAIN WATER 2.7 WIDE & VARIABLE



LEGEND

- | | | | | | |
|----------|----------------------------------|---------|-----------------------------------|---------|--|
| --- | EASEMENT FOR DRAINAGE & SERVICES | — E — | ELECTRICITY | ⊙ ⊙ ⊙ | SEWER MAINTENANCE CHAMBER, HOLE & TERMINAL MAINTENANCE SHAFT |
| ▤ | RETAINING WALL | — NBN — | COMMUNICATIONS | ⊙ | BATTER |
| — [] — | DRAINAGE LINE & PIT | — | STREET LIGHT | — [] — | VEHICULAR CROSSING & DRIVEWAY |
| — S — | SEWER MAIN | [EP] | ELECTRICAL PILLAR | — [] — | STREET TREE |
| — W — | WATER MAIN | [NBN] | COMMUNICATIONS PIT | | |
| — 58.0 — | FINISHED SURFACE LEVEL | ⊙ ⊙ ⊙ | WATER HYDRANT, STOP VALVE & SCOUR | | |

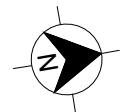

18/03/2026

This plan is provided solely for the purpose of providing an impression of the concept relating to the proposed development called 'Orchard Hills North', as well as the approximate location of existing and proposed third party facilities, services or destinations, and is not intended to be used for any other purpose. Legacy Group does not make any representation or give any warranty in relation to the future development of the site, the staging of any future development or the current or future location or existence of any facilities, services or destinations. The plan is based on the present intention of, and information available to, Legacy Group and the current known requirements of relevant authorities at the time of creation of the plan and details may change due to future circumstances. Any indications of distance or size are approximate and for indicative purposes only and are not to scale. The plan and any matters shown on or inferred from it do not give rise to a legally binding obligation on or representation or warranty by Legacy Group. Legacy Group accepts no liability for any loss or damage arising as a result of any reliance on this plan or its contents. Branding & Marketing by Delivery.net.au



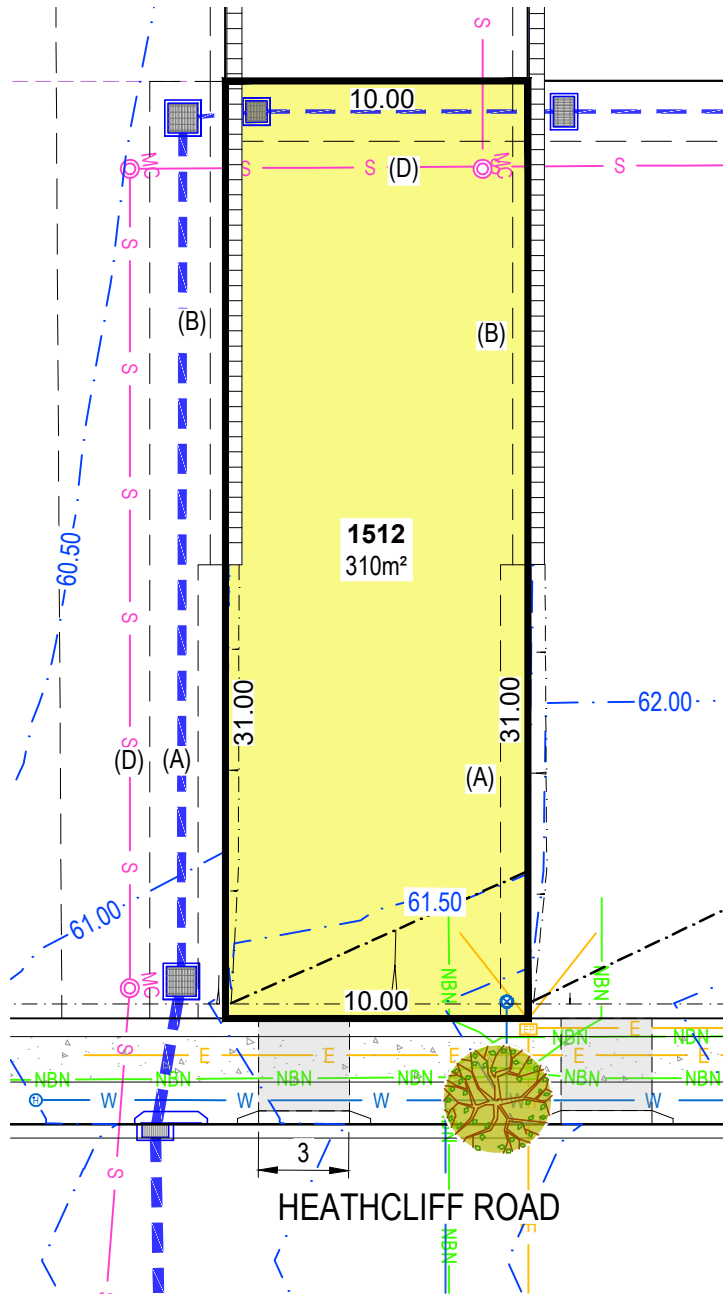

- (A) PROPOSED EASEMENT FOR ACCESS & MAINTENANCE 0.9m WIDE
- (B) PROPOSED EASEMENT FOR RETAINING WALL SUPPORT 0.5m WIDE
- (C) PROPOSED TEMPORARY EASEMENT TO DRAIN WATER 2.5m WIDE
- (D) PROPOSED EASEMENT TO DRAIN WATER 2.0m WIDE
- (H) PROPOSED EASEMENT TO DRAIN WATER 2.7 WIDE & VARIABLE



LEGEND

- | | | | | | |
|----------|----------------------------------|---------|-----------------------------------|---|--|
| --- | EASEMENT FOR DRAINAGE & SERVICES | — E — | ELECTRICITY | ⊙ | SEWER MAINTENANCE CHAMBER, HOLE & TERMINAL MAINTENANCE SHAFT |
| ▤ | RETAINING WALL | — NBN — | COMMUNICATIONS | ⊙ | BATTER |
| — S — | DRAINAGE LINE & PIT | — | STREET LIGHT | ⊙ | VEHICULAR CROSSING & DRIVEWAY |
| — W — | SEWER MAIN | ⊙ | ELECTRICAL PILLAR | ⊙ | STREET TREE |
| — 58.0 — | WATER MAIN | ⊙ | COMMUNICATIONS PIT | | |
| — 58.0 — | FINISHED SURFACE LEVEL | ⊙ | WATER HYDRANT, STOP VALVE & SCOUR | | |

18/03/2026

This plan is provided solely for the purpose of providing an impression of the concept relating to the proposed development called 'Orchard Hills North', as well as the approximate location of existing and proposed third party facilities, services or destinations, and is not intended to be used for any other purpose. Legacy Group does not make any representation or give any warranty in relation to the future development of the site, the staging of any future development or the current or future location or existence of any facilities, services or destinations. The plan is based on the present intention of, and information available to, Legacy Group and the current known requirements of relevant authorities at the time of creation of the plan and details may change due to future circumstances. Any indications of distance or size are approximate and for indicative purposes only and are not to scale. The plan and any matters shown on or inferred from it do not give rise to a legally binding obligation on or representation or warranty by Legacy Group. Legacy Group accepts no liability for any loss or damage arising as a result of any reliance on this plan or its contents. Branding & Marketing by Delivery.net.au