

LOT PLAN

ROAD 10

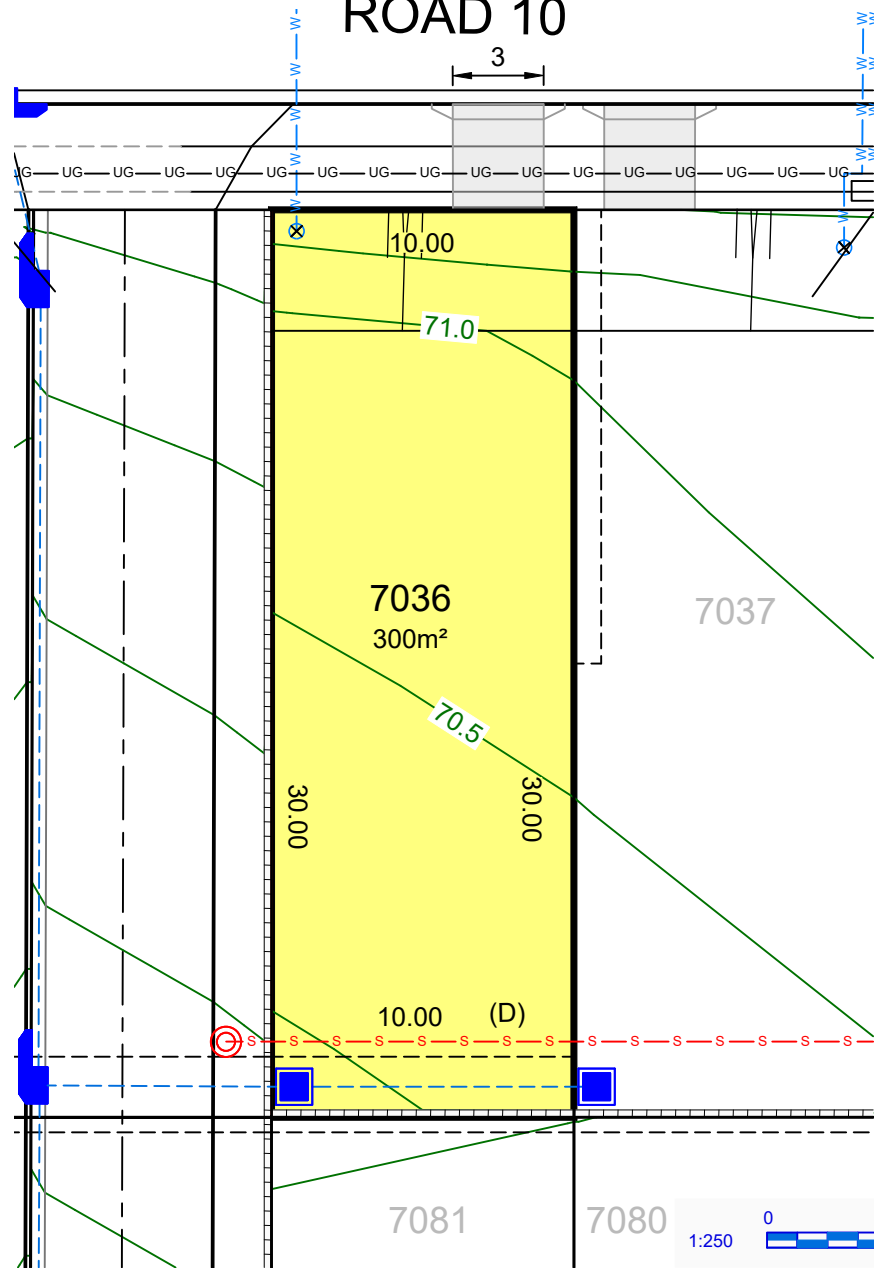

- (A) PROPOSED EASEMENT FOR ACCESS & MAINTENANCE 0.9 WIDE
- (C) PROPOSED EASEMENT FOR RETAINING WALL SUPPORT 0.5 WIDE
- (D) PROPOSED EASEMENT TO DRAIN WATER 2 WIDE
- (E) PROPOSED RIGHT OF CARRIAGEWAY VARIABLE WIDTH
- (F) PROPOSED EASEMENT TO DRAIN WATER 3 WIDE
- (G) PROPOSED EASEMENT TO DRAIN WATER (WHOLE OF LOT)

LEGEND

- EASEMENT FOR DRAINAGE & SERVICES
- ===== RETAINING WALL
- w—w—w— DRAINAGE LINE & PIT
- s—s—s— SEWER MAIN
- w—w—w— WATER MAIN
- 58.0— FINISHED SURFACE LEVEL

- UG—UG— COMMUNICATIONS & ELECTRICITY
- BATTER (MAX. 1:4)
- SEWER MAINTENANCE CHAMBER, HOLE & TERMINAL MAINTENANCE SHAFT
- x | * WATER HYDRANT, STOP VALVE, REDUCER & SCOUR

- DRIVEWAY LAYBACK
- Service Connection
- Street Light
- Pillar
- NBN
- NBN
- 1:1 BATTER (0.4m MAX. HT.)

This plan is provided solely for the purpose of providing an impression of the concept relating to the proposed development called 'Orchard Hills North', as well as the approximate location of existing and proposed third party facilities, services or destinations, and is not intended to be used for any other purpose. Legacy Property does not make any representation or give any warranty in relation to the future development of the site, the staging of any future development or the current or future location or existence of any facilities, services or destinations. The plan is based on the present intention of, and information available to, Legacy Property and the current known requirements of relevant authorities at the time of creation of the plan and details may change due to future circumstances. Any indications of distance or size are approximate and for indicative purposes only and are not to scale. The plan and any matters shown on or inferred from it do not give rise to a legally binding obligation on or representation or warranty by Legacy Property. Legacy Property accepts no liability for any loss or damage arising as a result of any reliance on this plan or its contents. Branding & Marketing by Delivery.net.au

SALES CENTRE
225 CADDENS RD,
CADDENS NSW 2747
ORCHARDHILLSNORTH.COM.AU
1800 834 339



LOT PLAN

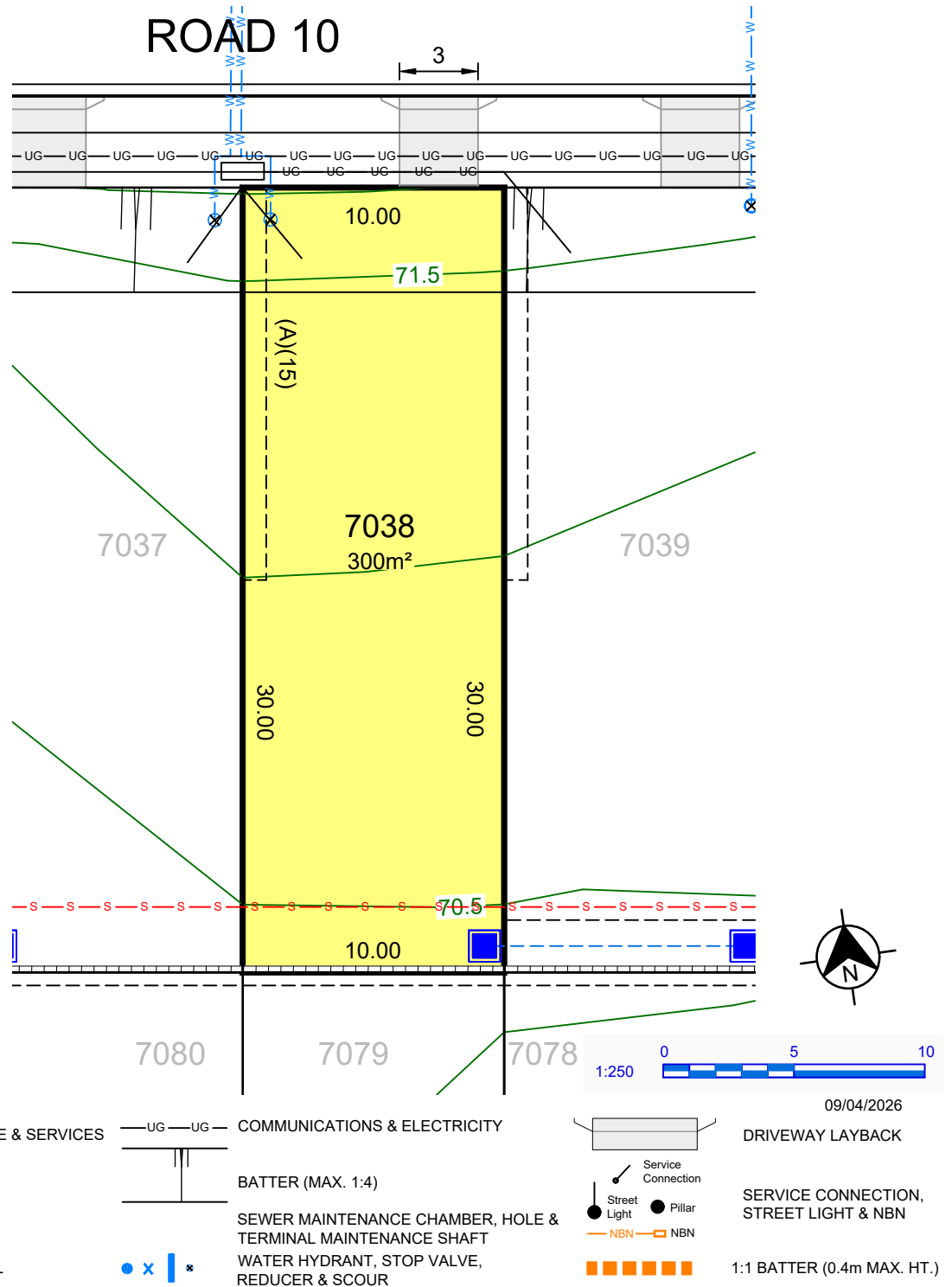

This plan is provided solely for the purpose of providing an impression of the concept relating to the proposed development called 'Orchard Hills North', as well as the approximate location of existing and proposed third party facilities, services or destinations, and is not intended to be used for any other purpose. Legacy Property does not make any representation or give any warranty in relation to the future development of the site, the staging of any future development or the current or future location or existence of any facilities, services or destinations. The plan is based on the present intention of, and information available to, Legacy Property and the current known requirements of relevant authorities at the time of creation of the plan and details may change due to future circumstances. Any indications of distance or size are approximate and for indicative purposes only and are not to scale. The plan and any matters shown on or inferred from it do not give rise to a legally binding obligation on or representation or warranty by Legacy Property. Legacy Property accepts no liability for any loss or damage arising as a result of any reliance on this plan or its contents.

Branding & Marketing by Delivery.net.au

SALES CENTRE
225 CADDENS RD,
CADDENS NSW 2747
ORCHARDHILLSNORTH.COM.AU
1800 834 339



LOT PLAN

ROAD 10

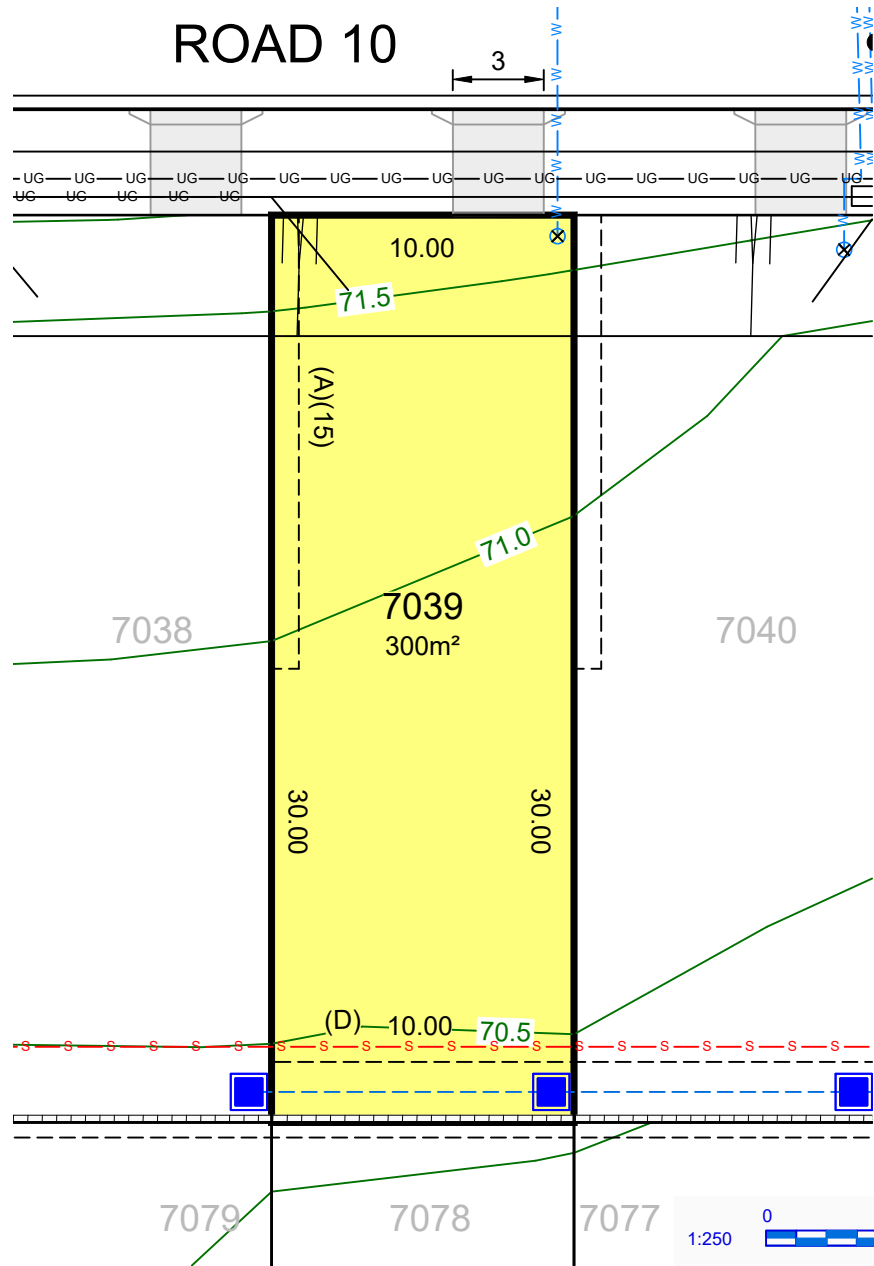

- (A) PROPOSED EASEMENT FOR ACCESS & MAINTENANCE 0.9 WIDE
- (C) PROPOSED EASEMENT FOR RETAINING WALL SUPPORT 0.5 WIDE
- (D) PROPOSED EASEMENT TO DRAIN WATER 2 WIDE
- (E) PROPOSED RIGHT OF CARRIAGEWAY VARIABLE WIDTH
- (F) PROPOSED EASEMENT TO DRAIN WATER 3 WIDE
- (G) PROPOSED EASEMENT TO DRAIN WATER (WHOLE OF LOT)

LEGEND

- EASEMENT FOR DRAINAGE & SERVICES
- ===== RETAINING WALL
- DRAINAGE LINE & PIT
- s-s- SEWER MAIN
- w- WATER MAIN
- 58.0- FINISHED SURFACE LEVEL

- UG—UG— COMMUNICATIONS & ELECTRICITY
- ||| BATTER (MAX. 1:4)
- SEWER MAINTENANCE CHAMBER, HOLE & TERMINAL MAINTENANCE SHAFT
- x | * WATER HYDRANT, STOP VALVE, REDUCER & SCOUR

- ▭ DRIVEWAY LAYBACK
- Service Connection
- Street Light
- Pillar
- NBN— NBN
- 1:1 BATTER (0.4m MAX. HT.)

09/04/2026

This plan is provided solely for the purpose of providing an impression of the concept relating to the proposed development called 'Orchard Hills North', as well as the approximate location of existing and proposed third party facilities, services or destinations, and is not intended to be used for any other purpose. Legacy Property does not make any representation or give any warranty in relation to the future development of the site, the staging of any future development or the current or future location or existence of any facilities, services or destinations. The plan is based on the present intention of, and information available to, Legacy Property and the current known requirements of relevant authorities at the time of creation of the plan and details may change due to future circumstances. Any indications of distance or size are approximate and for indicative purposes only and are not to scale. The plan and any matters shown on or inferred from it do not give rise to a legally binding obligation on or representation or warranty by Legacy Property. Legacy Property accepts no liability for any loss or damage arising as a result of any reliance on this plan or its contents. Branding & Marketing by Delivery.net.au

SALES CENTRE
225 CADDENS RD,
CADDENS NSW 2747
ORCHARDHILLSNORTH.COM.AU
1800 834 339



LOT PLAN

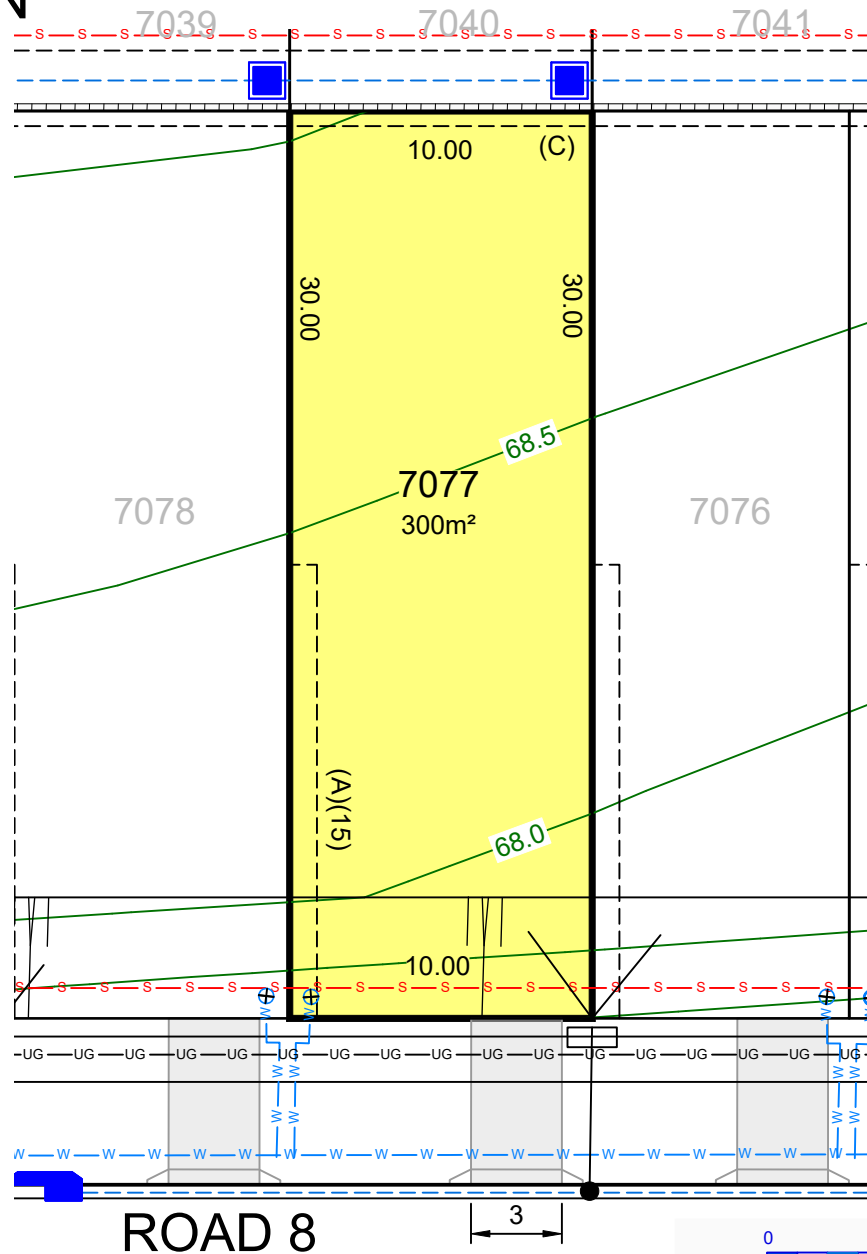

- (A) PROPOSED EASEMENT FOR ACCESS & MAINTENANCE 0.9 WIDE
- (C) PROPOSED EASEMENT FOR RETAINING WALL SUPPORT 0.5 WIDE
- (D) PROPOSED EASEMENT TO DRAIN WATER 2 WIDE
- (E) PROPOSED RIGHT OF CARRIAGEWAY VARIABLE WIDTH
- (F) PROPOSED EASEMENT TO DRAIN WATER 3 WIDE
- (G) PROPOSED EASEMENT TO DRAIN WATER (WHOLE OF LOT)

LEGEND

- | | | | | | |
|-------|----------------------------------|---------|--------------------------------------------------------------|--|----------------------------|
| ----- | EASEMENT FOR DRAINAGE & SERVICES | —UG—UG— | COMMUNICATIONS & ELECTRICITY | | DRIVEWAY LAYBACK |
| | RETAINING WALL | | BATTER (MAX. 1:4) | | SERVICE CONNECTION |
| | DRAINAGE LINE & PIT | | SEWER MAINTENANCE CHAMBER, HOLE & TERMINAL MAINTENANCE SHAFT | | STREET LIGHT |
| | SEWER MAIN | | WATER HYDRANT, STOP VALVE, REDUCER & SCOUR | | PILLAR |
| | WATER MAIN | | | | NBN |
| | FINISHED SURFACE LEVEL | | | | 1:1 BATTER (0.4m MAX. HT.) |

This plan is provided solely for the purpose of providing an impression of the concept relating to the proposed development called 'Orchard Hills North', as well as the approximate location of existing and proposed third party facilities, services or destinations, and is not intended to be used for any other purpose. Legacy Property does not make any representation or give any warranty in relation to the future development of the site, the staging of any future development or the current or future location or existence of any facilities, services or destinations. The plan is based on the present intention of, and information available to, Legacy Property and the current known requirements of relevant authorities at the time of creation of the plan and details may change due to future circumstances. Any indications of distance or size are approximate and for indicative purposes only and are not to scale. The plan and any matters shown on or inferred from it do not give rise to a legally binding obligation on or representation or warranty by Legacy Property. Legacy Property accepts no liability for any loss or damage arising as a result of any reliance on this plan or its contents. Branding & Marketing by Delivery.net.au

SALES CENTRE
225 CADDENS RD,
CADDENS NSW 2747
ORCHARDHILLSNORTH.COM.AU
1800 834 339



LOT PLAN

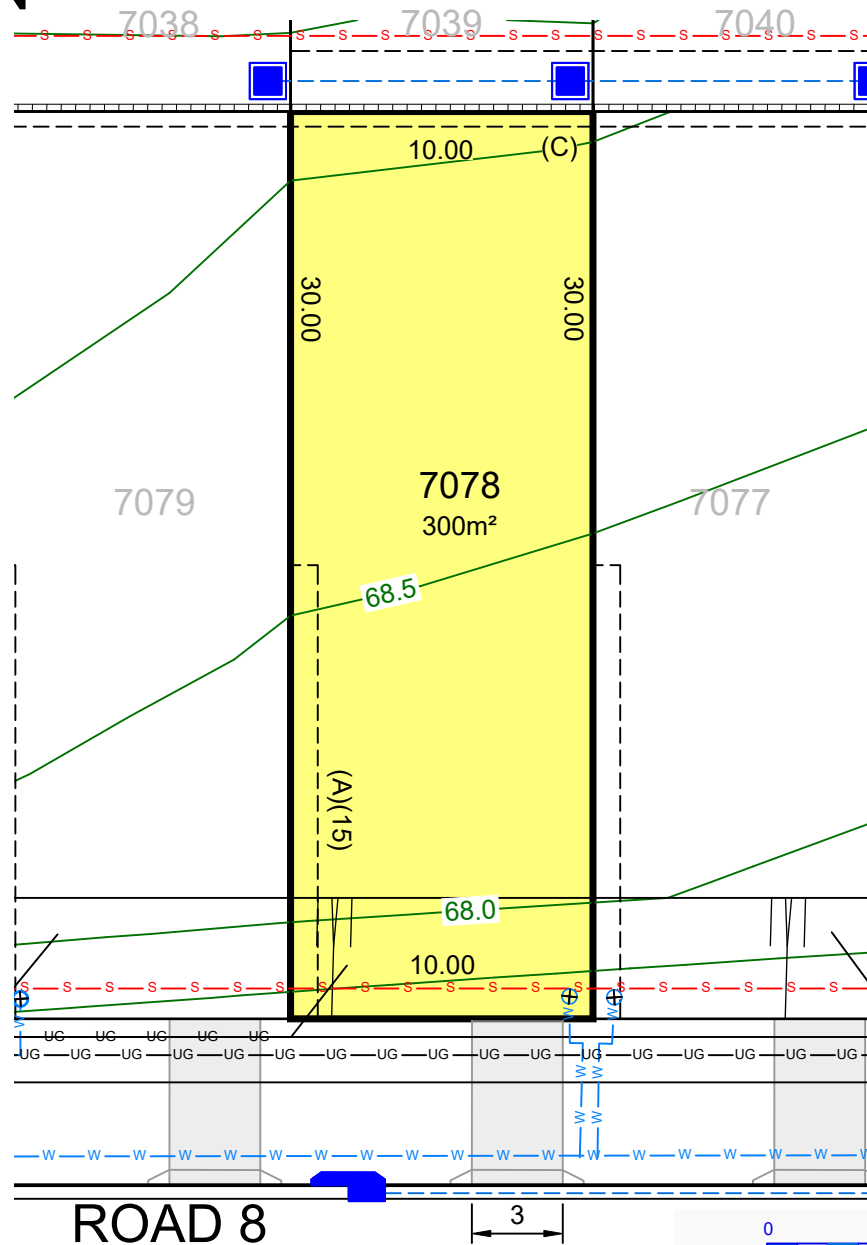

- (A) PROPOSED EASEMENT FOR ACCESS & MAINTENANCE 0.9 WIDE
- (C) PROPOSED EASEMENT FOR RETAINING WALL SUPPORT 0.5 WIDE
- (D) PROPOSED EASEMENT TO DRAIN WATER 2 WIDE
- (E) PROPOSED RIGHT OF CARRIAGEWAY VARIABLE WIDTH
- (F) PROPOSED EASEMENT TO DRAIN WATER 3 WIDE
- (G) PROPOSED EASEMENT TO DRAIN WATER (WHOLE OF LOT)

LEGEND

- | | | | | | |
|-------|----------------------------------|---------|--------------------------------------------------------------|--|----------------------------|
| ----- | EASEMENT FOR DRAINAGE & SERVICES | —UG—UG— | COMMUNICATIONS & ELECTRICITY | | DRIVEWAY LAYBACK |
| | RETAINING WALL | | BATTER (MAX. 1:4) | | SERVICE CONNECTION |
| | DRAINAGE LINE & PIT | | SEWER MAINTENANCE CHAMBER, HOLE & TERMINAL MAINTENANCE SHAFT | | STREET LIGHT |
| | SEWER MAIN | | WATER HYDRANT, STOP VALVE, REDUCER & SCOUR | | PILLAR |
| | WATER MAIN | | | | NBN |
| | FINISHED SURFACE LEVEL | | | | 1:1 BATTER (0.4m MAX. HT.) |

This plan is provided solely for the purpose of providing an impression of the concept relating to the proposed development called 'Orchard Hills North', as well as the approximate location of existing and proposed third party facilities, services or destinations, and is not intended to be used for any other purpose. Legacy Property does not make any representation or give any warranty in relation to the future development of the site, the staging of any future development or the current or future location or existence of any facilities, services or destinations. The plan is based on the present intention of, and information available to, Legacy Property and the current known requirements of relevant authorities at the time of creation of the plan and details may change due to future circumstances. Any indications of distance or size are approximate and for indicative purposes only and are not to scale. The plan and any matters shown on or inferred from it do not give rise to a legally binding obligation on or representation or warranty by Legacy Property. Legacy Property accepts no liability for any loss or damage arising as a result of any reliance on this plan or its contents. Branding & Marketing by Delivery.net.au

SALES CENTRE
225 CADDENS RD,
CADDENS NSW 2747
ORCHARDHILLSNORTH.COM.AU
1800 834 339



LOT PLAN

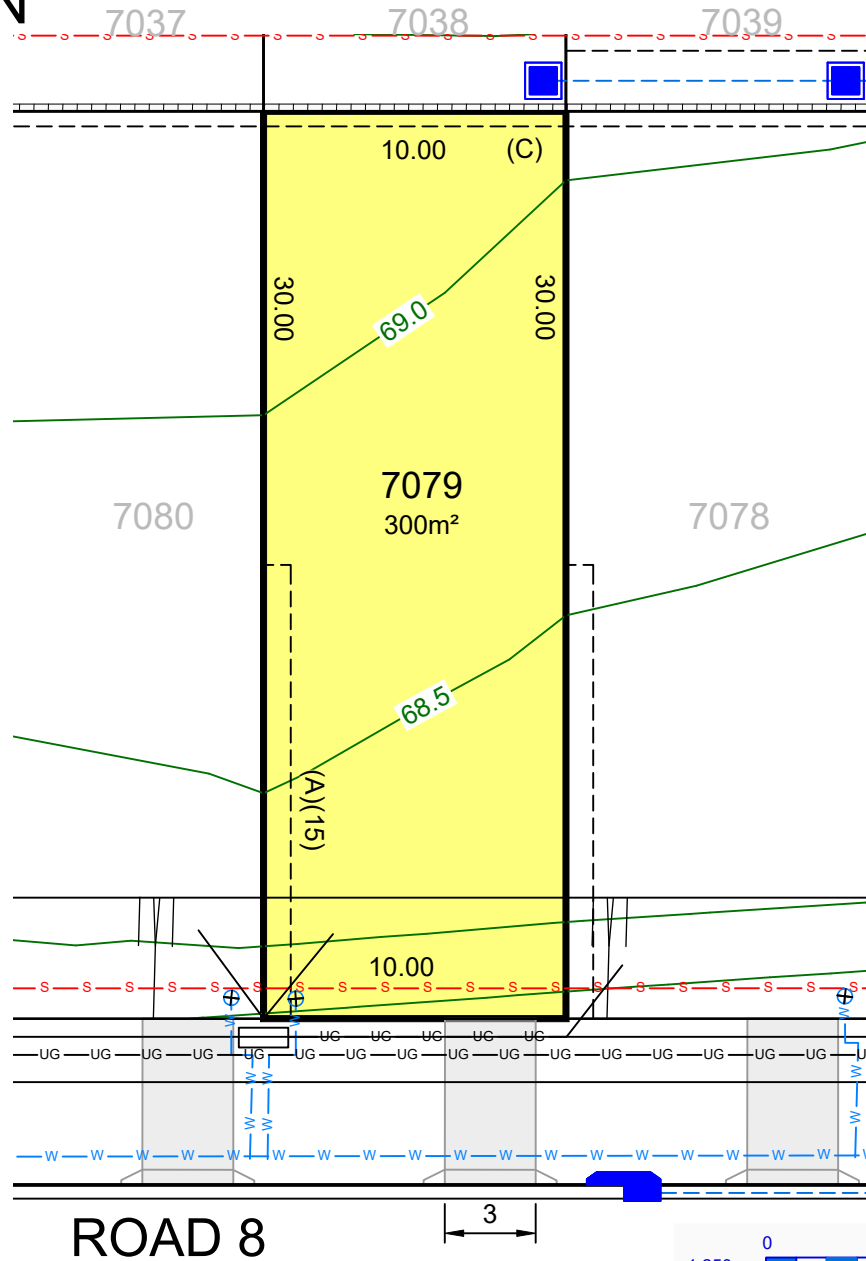

- (A) PROPOSED EASEMENT FOR ACCESS & MAINTENANCE 0.9 WIDE
- (C) PROPOSED EASEMENT FOR RETAINING WALL SUPPORT 0.5 WIDE
- (D) PROPOSED EASEMENT TO DRAIN WATER 2 WIDE
- (E) PROPOSED RIGHT OF CARRIAGEWAY VARIABLE WIDTH
- (F) PROPOSED EASEMENT TO DRAIN WATER 3 WIDE
- (G) PROPOSED EASEMENT TO DRAIN WATER (WHOLE OF LOT)

LEGEND

- | | | | | | |
|-------|----------------------------------|---------|--------------------------------------------------------------|--|----------------------------|
| ----- | EASEMENT FOR DRAINAGE & SERVICES | —UG—UG— | COMMUNICATIONS & ELECTRICITY | | DRIVEWAY LAYBACK |
| | RETAINING WALL | | BATTER (MAX. 1:4) | | SERVICE CONNECTION |
| | DRAINAGE LINE & PIT | | SEWER MAINTENANCE CHAMBER, HOLE & TERMINAL MAINTENANCE SHAFT | | STREET LIGHT |
| | SEWER MAIN | | WATER HYDRANT, STOP VALVE, REDUCER & SCOUR | | PILLAR |
| | WATER MAIN | | | | NBN |
| | FINISHED SURFACE LEVEL | | | | 1:1 BATTER (0.4m MAX. HT.) |

This plan is provided solely for the purpose of providing an impression of the concept relating to the proposed development called 'Orchard Hills North', as well as the approximate location of existing and proposed third party facilities, services or destinations, and is not intended to be used for any other purpose. Legacy Property does not make any representation or give any warranty in relation to the future development of the site, the staging of any future development or the current or future location or existence of any facilities, services or destinations. The plan is based on the present intention of, and information available to, Legacy Property and the current known requirements of relevant authorities at the time of creation of the plan and details may change due to future circumstances. Any indications of distance or size are approximate and for indicative purposes only and are not to scale. The plan and any matters shown on or inferred from it do not give rise to a legally binding obligation on or representation or warranty by Legacy Property. Legacy Property accepts no liability for any loss or damage arising as a result of any reliance on this plan or its contents.

Branding & Marketing by Delivery.net.au

SALES CENTRE
225 CADDENS RD,
CADDENS NSW 2747
ORCHARDHILLSNORTH.COM.AU
1800 834 339



09/04/2026

LOT PLAN

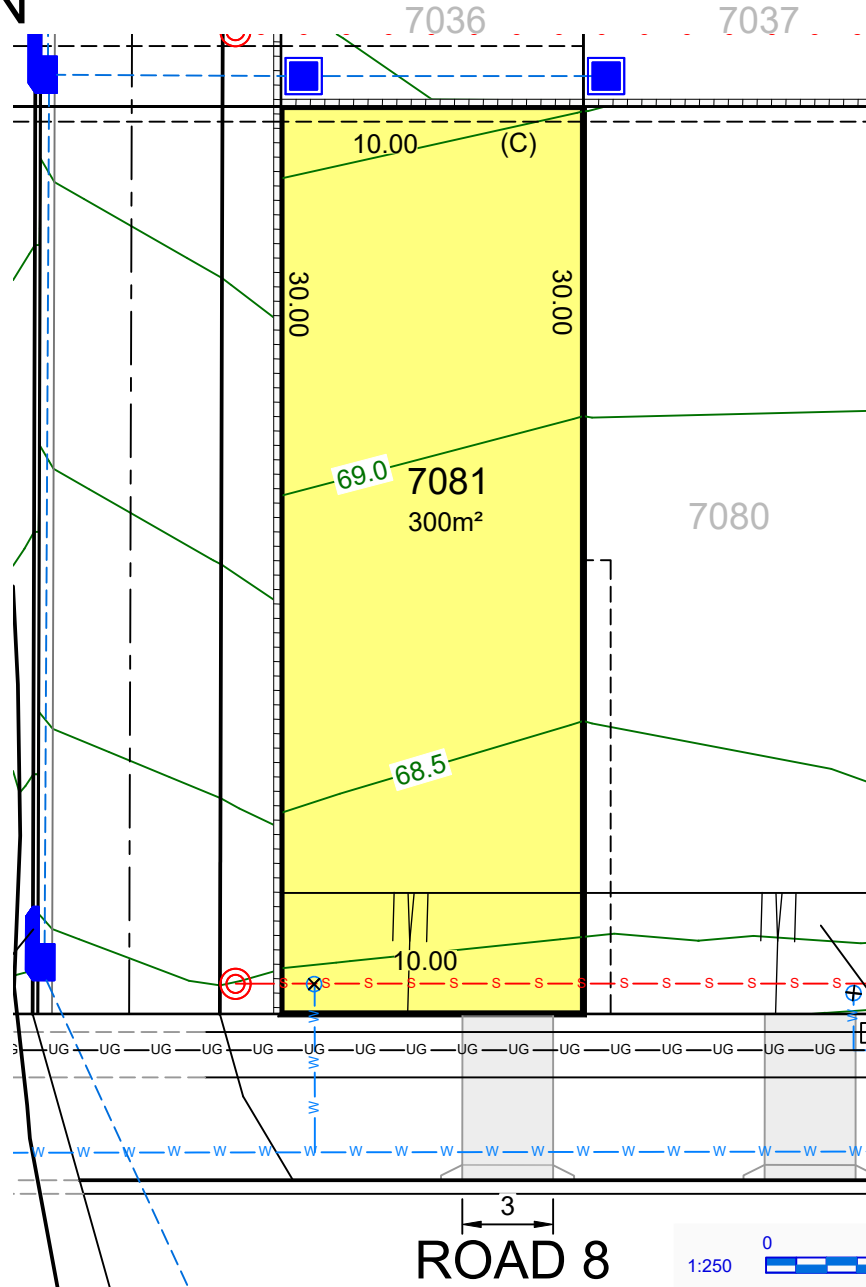

- (A) PROPOSED EASEMENT FOR ACCESS & MAINTENANCE 0.9 WIDE
- (C) PROPOSED EASEMENT FOR RETAINING WALL SUPPORT 0.5 WIDE
- (D) PROPOSED EASEMENT TO DRAIN WATER 2 WIDE
- (E) PROPOSED RIGHT OF CARRIAGEWAY VARIABLE WIDTH
- (F) PROPOSED EASEMENT TO DRAIN WATER 3 WIDE
- (G) PROPOSED EASEMENT TO DRAIN WATER (WHOLE OF LOT)

LEGEND

- EASEMENT FOR DRAINAGE & SERVICES
- ===== RETAINING WALL
- DRAINAGE LINE & PIT
- s—s— SEWER MAIN
- w—w— WATER MAIN
- 58.0— FINISHED SURFACE LEVEL

- UG—UG— COMMUNICATIONS & ELECTRICITY
- ||| BATTER (MAX. 1:4)
- ⊗ SEWER MAINTENANCE CHAMBER, HOLE & TERMINAL MAINTENANCE SHAFT
- x | * WATER HYDRANT, STOP VALVE, REDUCER & SCOUR

- ▭ DRIVEWAY LAYBACK
- Service Connection
- Street Light ● Pillar
- NBN— NBN
- ■ ■ ■ ■ 1:1 BATTER (0.4m MAX. HT.)

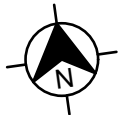

09/04/2026

This plan is provided solely for the purpose of providing an impression of the concept relating to the proposed development called 'Orchard Hills North', as well as the approximate location of existing and proposed third party facilities, services or destinations, and is not intended to be used for any other purpose. Legacy Property does not make any representation or give any warranty in relation to the future development of the site, the staging of any future development or the current or future location or existence of any facilities, services or destinations. The plan is based on the present intention of, and information available to, Legacy Property and the current known requirements of relevant authorities at the time of creation of the plan and details may change due to future circumstances. Any indications of distance or size are approximate and for indicative purposes only and are not to scale. The plan and any matters shown on or inferred from it do not give rise to a legally binding obligation on or representation or warranty by Legacy Property. Legacy Property accepts no liability for any loss or damage arising as a result of any reliance on this plan or its contents. Branding & Marketing by Delivery.net.au

SALES CENTRE
225 CADDENS RD,
CADDENS NSW 2747
ORCHARDHILLSNORTH.COM.AU
1800 834 339

